

Spot Lamp Kit Installation

Table 1: [Kit Contents](#)

Table 2: [Power Distribution Box In-line 8-Way Connector](#)

Installation Instructions Part Number

84860343

Kit Contents

QTY	Description
2	Pod Light
1	RHS Bracket
1	RHS Gasket (installed in bracket)
1	LHS Bracket
1	LHS Gasket (installed on bracket)
4	M6 Bolt
4	Split Washer for M6
2	Lamp cover
1	Harness Assembly
2	2-way Sealed Male Connector
1	Fuse 15A
1	Relay
10	Tie Strap
2	Hollow Bolt
2	Hollow Bolt Nut
1	Installation Instructions

Preliminary Procedures

Warning: Always ensure the Battery Maintenance Mode is inactive before disconnecting the low voltage 12 volt battery (or batteries). This mode can be active with the ignition off, regardless of whether the vehicle charging cord is plugged in or not. When this mode is active, the on-board high voltage battery charger(s) will energize the 12 volt battery

cables and charge the 12 volt battery (or batteries). Disconnecting any battery cables while this mode is active may result in an electrical shock or a burn from hot battery cable leads.

1. Check the 12 volt battery voltage with a digital multimeter before disconnecting any battery cables leads. If the voltage is 13.5 volts or above, the Battery Maintenance Mode is active. The technician must wait for the T18 battery charger to deactivate before disconnecting the battery negative cable. [Charging System Description and Operation](#)
2. Disconnect the 12 volt negative battery cable. Refer to [Battery Negative Cable Disconnection and Connection](#) in Vehicle Service Manual.
Note: This accessory requires the battery distribution engine compartment fuse block and must be purchased separately.
3. Install the battery distribution engine compartment fuse block. Refer to [Battery Distribution Engine Compartment Fuse Block Package Installation](#) in Vehicle Accessory Installation Manual.
4. Read all instructions before performing procedure.
5. Inspect KIT to verify all parts are included.
6. Remove the front trim finish compartment. Refer to [Front Trim Finish Compartment Replacement](#) in Vehicle Service Manual.

Procedure

1. Remove the left and right front fender ornamentation vents. Refer to [Front Fender Ornamentation Vent Replacement](#) in Vehicle Service Manual.

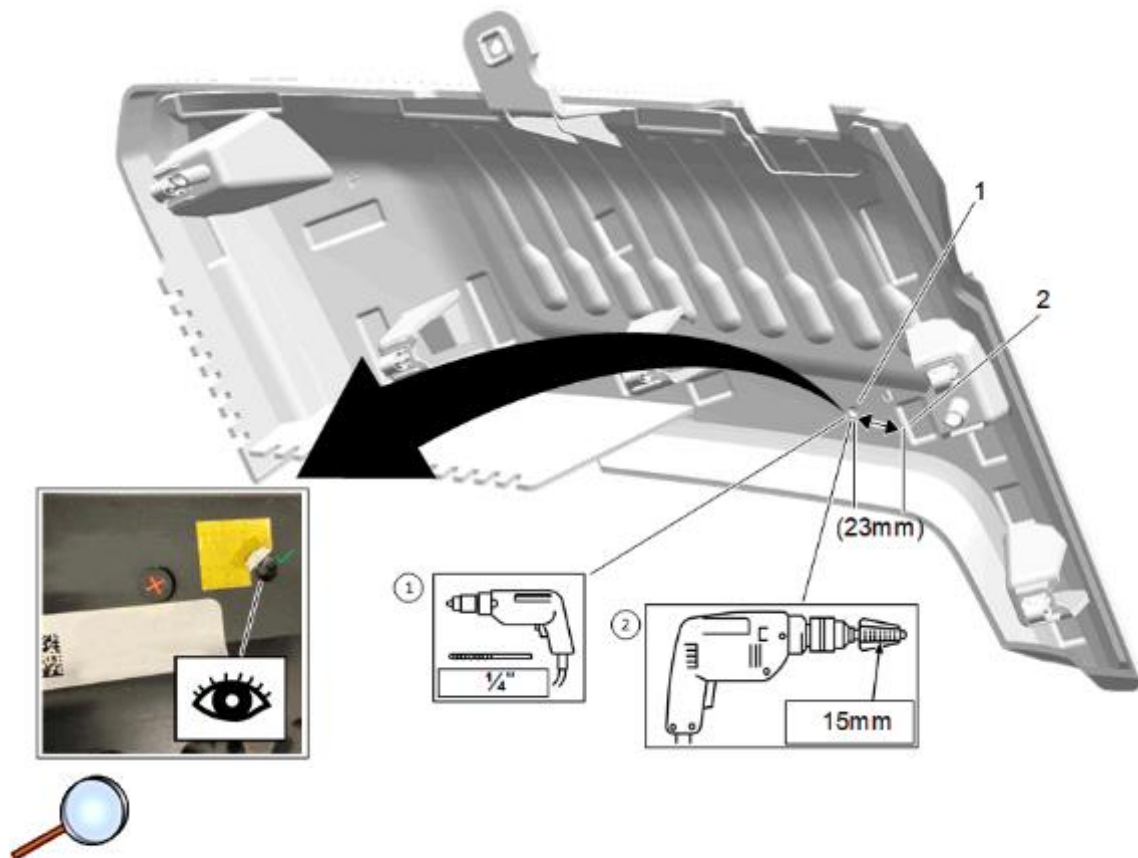

Caution: Always check size and position of all holes before drilling. Failing to do so may cause damage to the vehicle, misalignment of components or the inability to install the accessory.

Note: Remove yellow sticker if dimple for pilot hole is not visible.

Note: Dimple (1) is approximately 23mm from heat stake patch (2).

- Using the dimple on the underside of fender ornamentation vent (1), drill a pilot hole using a 1/4" drill bit and then use a step drill bit and drill a 15mm hole. Repeat for opposite fender ornamentation vent

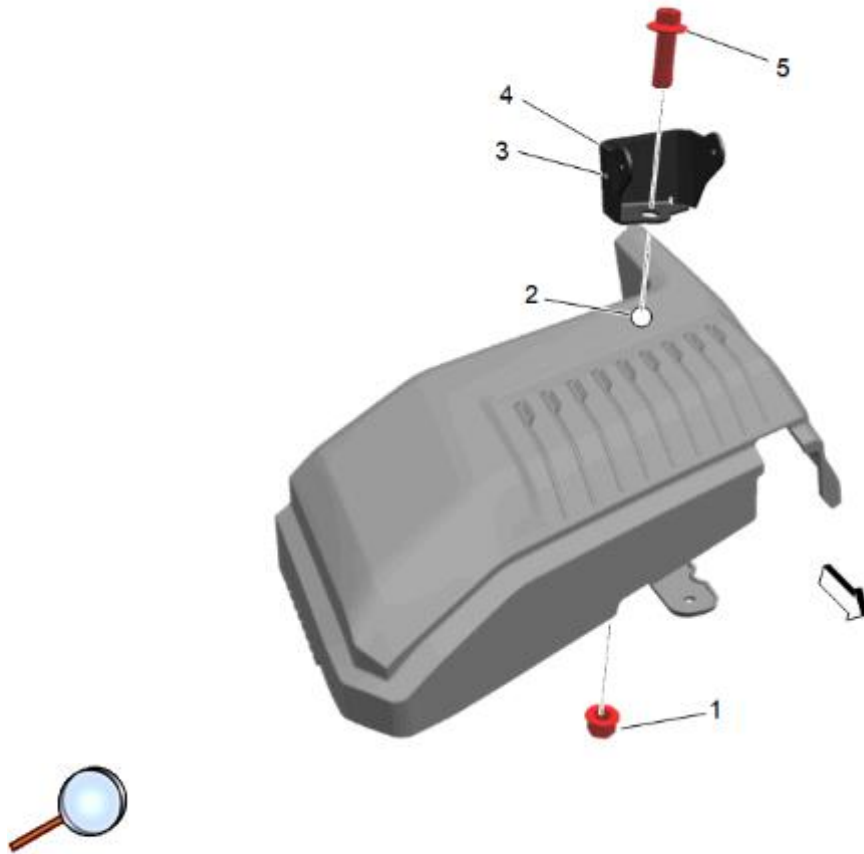

© 2024 General Motors. All rights reserved.

Caution: Use the correct fastener in the correct location. Replacement fasteners must be the correct part number for that application. Fasteners requiring replacement or fasteners requiring the use of thread locking compound or sealant are identified in the service procedure. Do not use paints, lubricants, or corrosion inhibitors on fasteners or fastener joint surfaces unless specified. These coatings affect fastener torque and joint clamping force and may damage the fastener. Use the correct tightening sequence and specifications when installing fasteners in order to avoid damage to parts and systems.

Note: Position bracket with unused hole (3) inboard of vehicle.

- Position bracket (4) with gasket to drilled hole (2) in fender ornamentation vent and secure with the with hollow bolt (5) and nut (1). Make sure bracket is straight and tighten nut to 15 N.m (11 lb ft). Repeat step for opposite side.

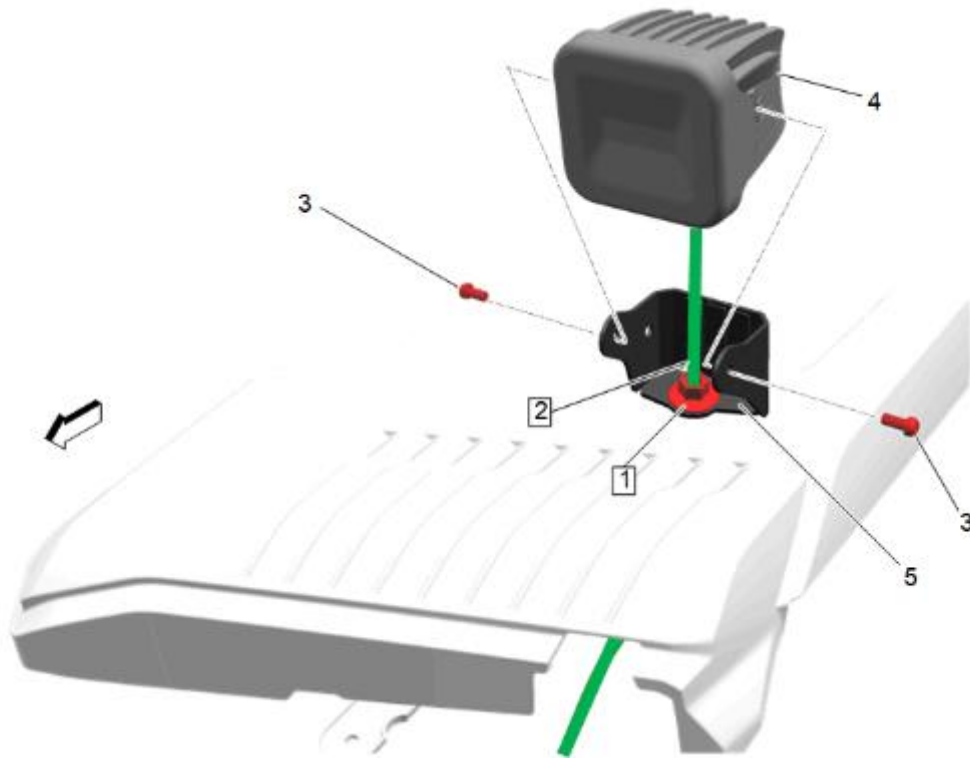

4. Route lamp pigtail harness (2) through hollow bolt (1).
5. Apply Loctite 242® Thread locker US P/N 12345382 (Canadian P/N 10953489), or equivalent, on M6 bolts (3).
6. Position lamp (4) to bracket (5) and secure with M6 bolts (3). Tighten the M6 bolts to 5 N.m (44 lb in). Repeat step for opposite side.
7. Reinstall the left and right front fender ornamentation vents with lamps. Refer to [Front Fender Ornamentation Vent Replacement](#) in Vehicle Service Manual.

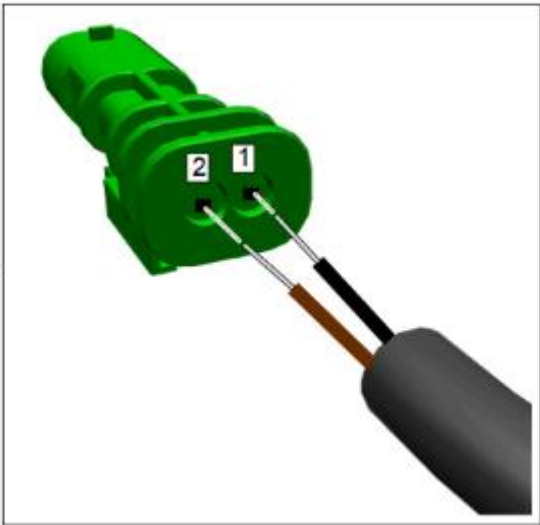
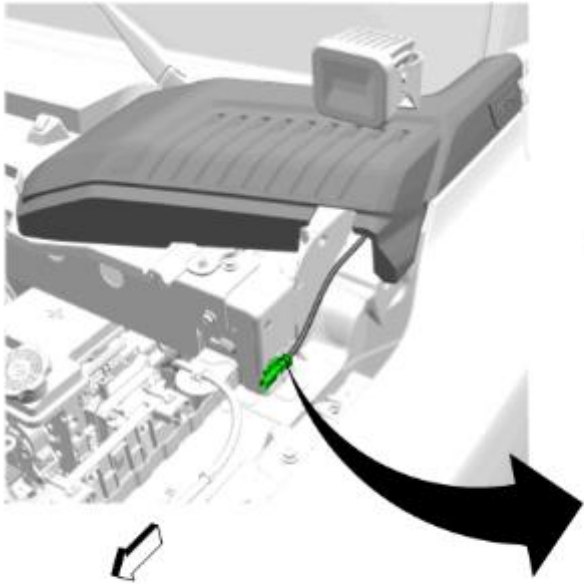

8. On the lamp pigtail harness, locate supplied 2-way connector and insert the Black circuit of pigtail harness into cavity 1 and insert the Brown circuit of pigtail harness into cavity 2. Repeat step for opposite side lamp pigtail harness.

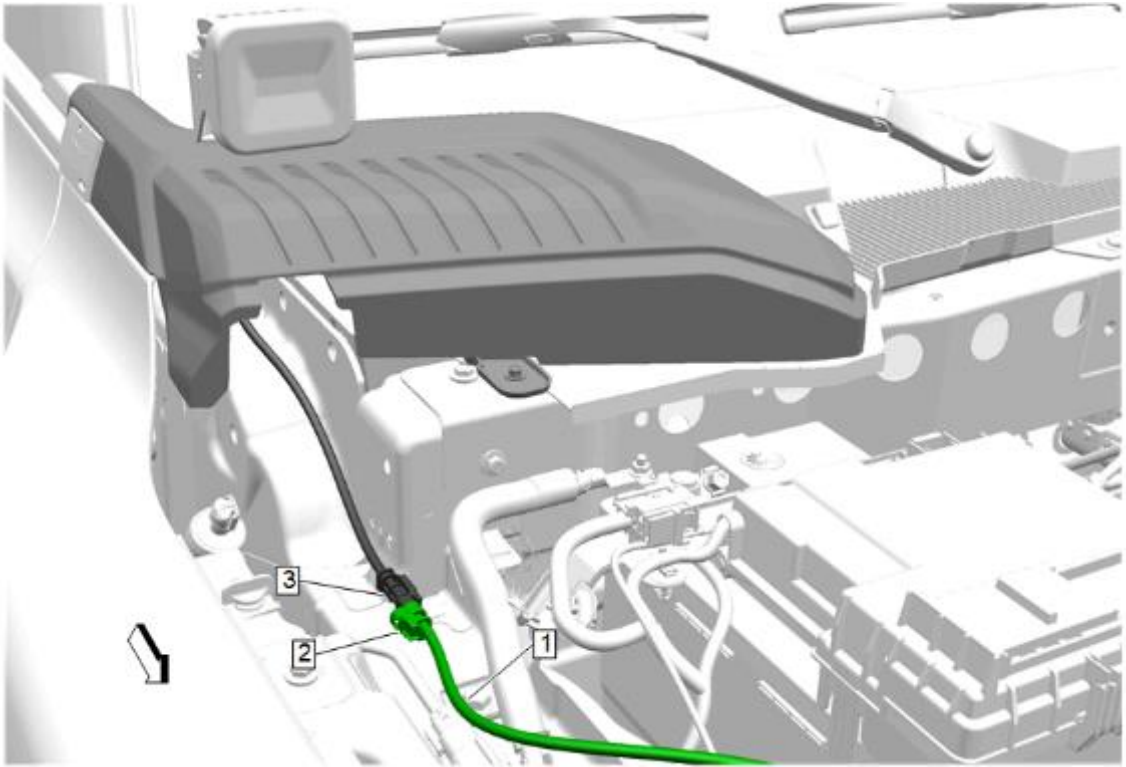

9. Starting from the passenger side, connect the passenger lamp pigtail connector (3) to the connector (2) on supplied harness (1).

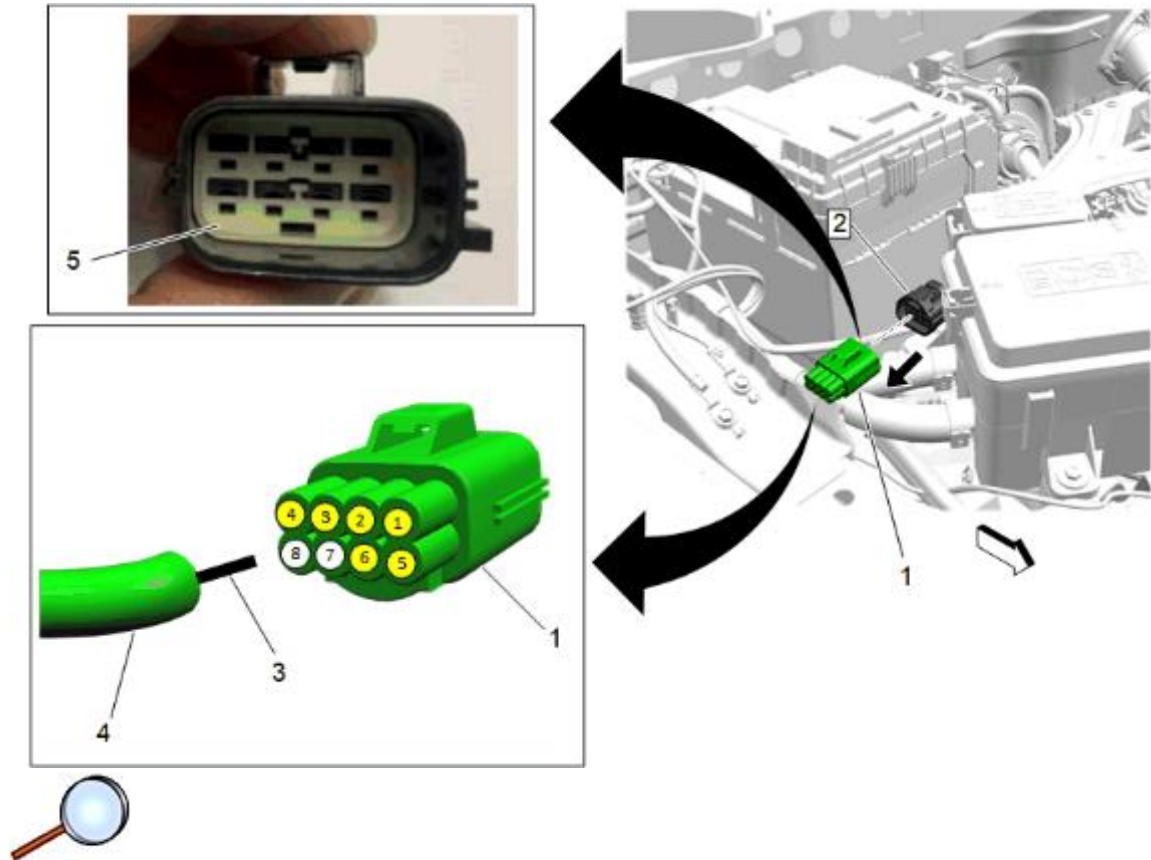

Note: Refer to the Power Distribution Box In-line 8-Way Connector table at the end of these instructions.

Note: Remove the cavity plug from the first non-used available location starting with #1 toward #6 (Do Not Use #7 or #8).

10. Remove the 8-way connector (1) from the power distribution box in-line connector (2).
11. Inside the 8-way connector (1), unseat the TPA (5) with a suitable hook tool.
12. Remove the cavity plug from the selected cavity and install terminal (3) of main harness (4) into 8-way connector (1) until seated.
13. Snap the TPA (5) back into position inside 8-way connector (1) to secure terminal pin.

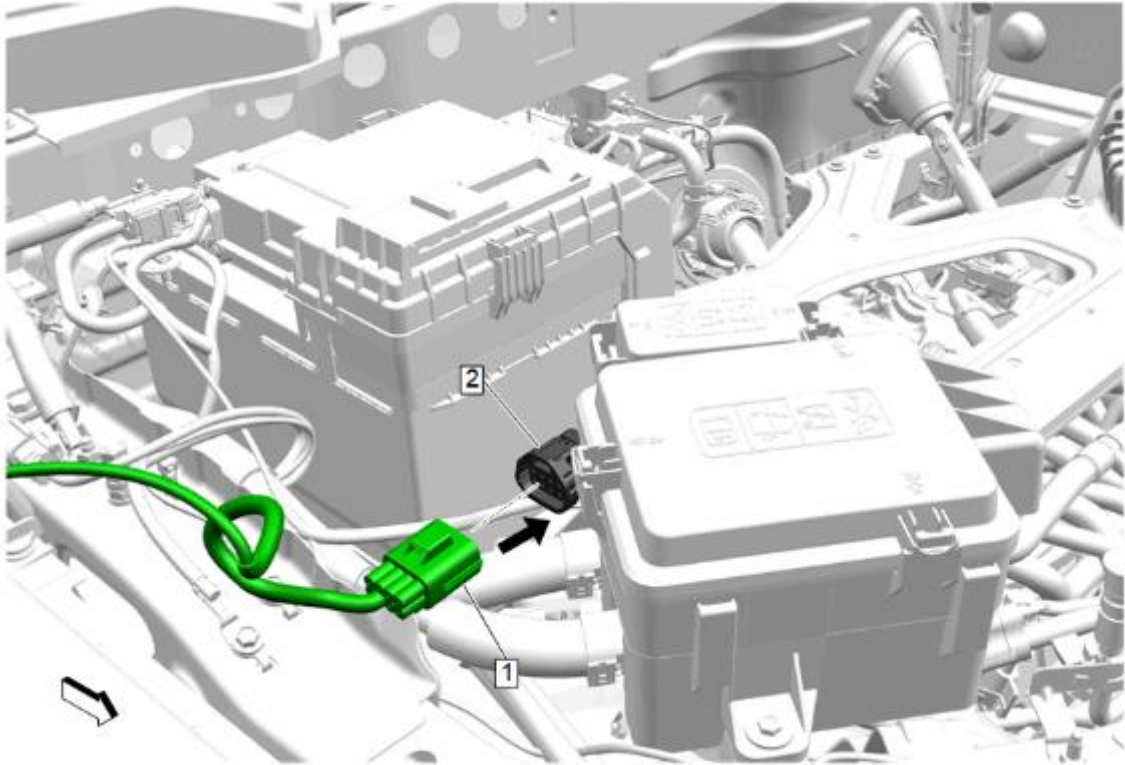

14. Connect the 8-way connector (1) to the power distribution box in-line connector (2).

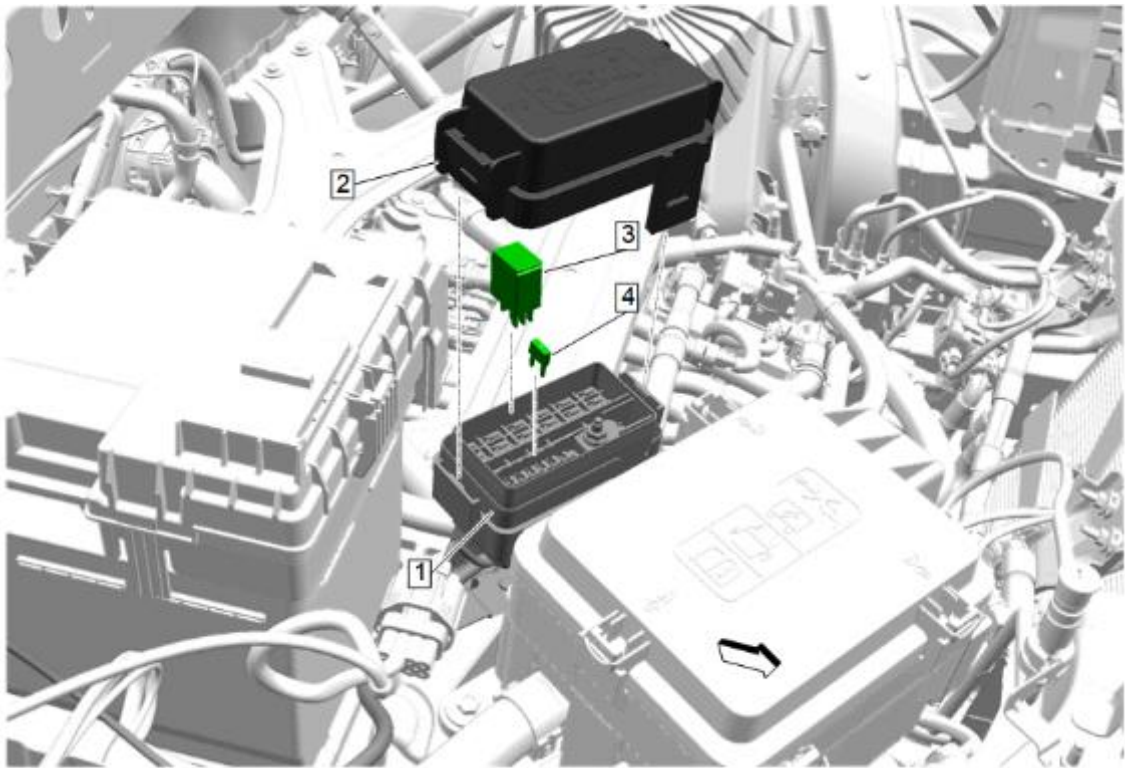

15. Remove cover (2) from the power distribution box (1).

16. Install relay (3) and fuse (4) to power distribution box cavity that corresponds to the previously selected cavity on the power distribution box in-line 8-way connector
17. Reinstall cover (2) to the power distribution box (1).

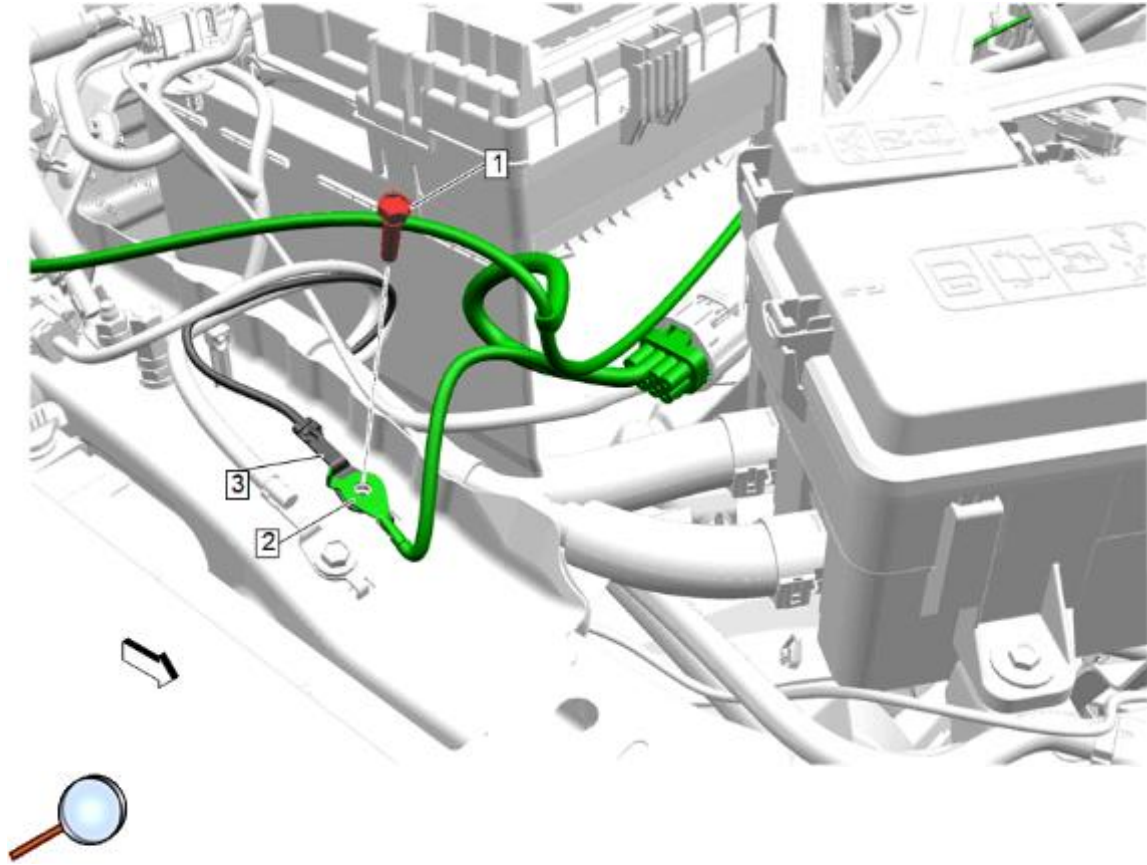

© 2024 General Motors. All rights reserved.

18. Remove the existing vehicle wiring ground bolt (1) near the electrical center and stack the accessory harness ring terminal (2) over the vehicle ground terminal (3).
19. Reinstall ground bolt (1) and tighten to 9 N.m (80 lb in).

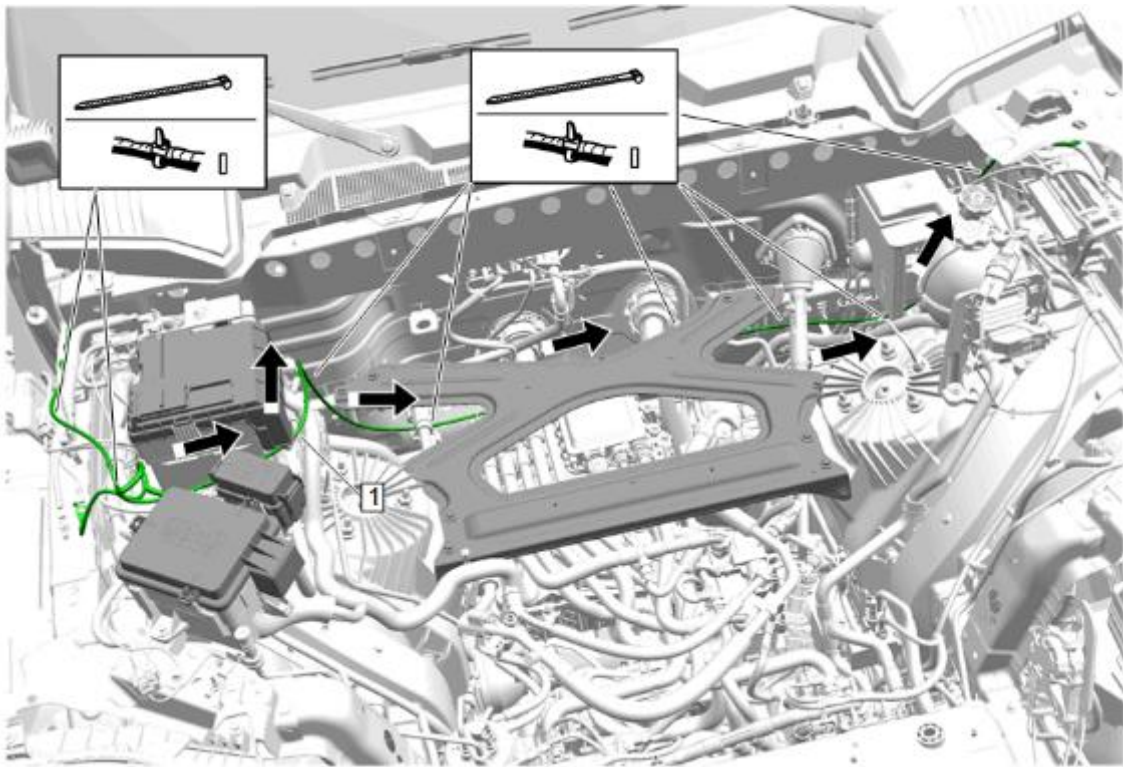

20. On the passenger side, route the lamp main harness (1) alongside the electrical center, then between the electrical center and power distribution box. Continue to route harness to the driver side along the front of dash area under the "X" bracket, below the HVAC lines and steering shaft

Note: Make sure harness is out of the way of any moving parts or sharp objects.

21. Secure harness with tie straps to existing vehicle harness in areas as shown. Trim excess of tie straps.

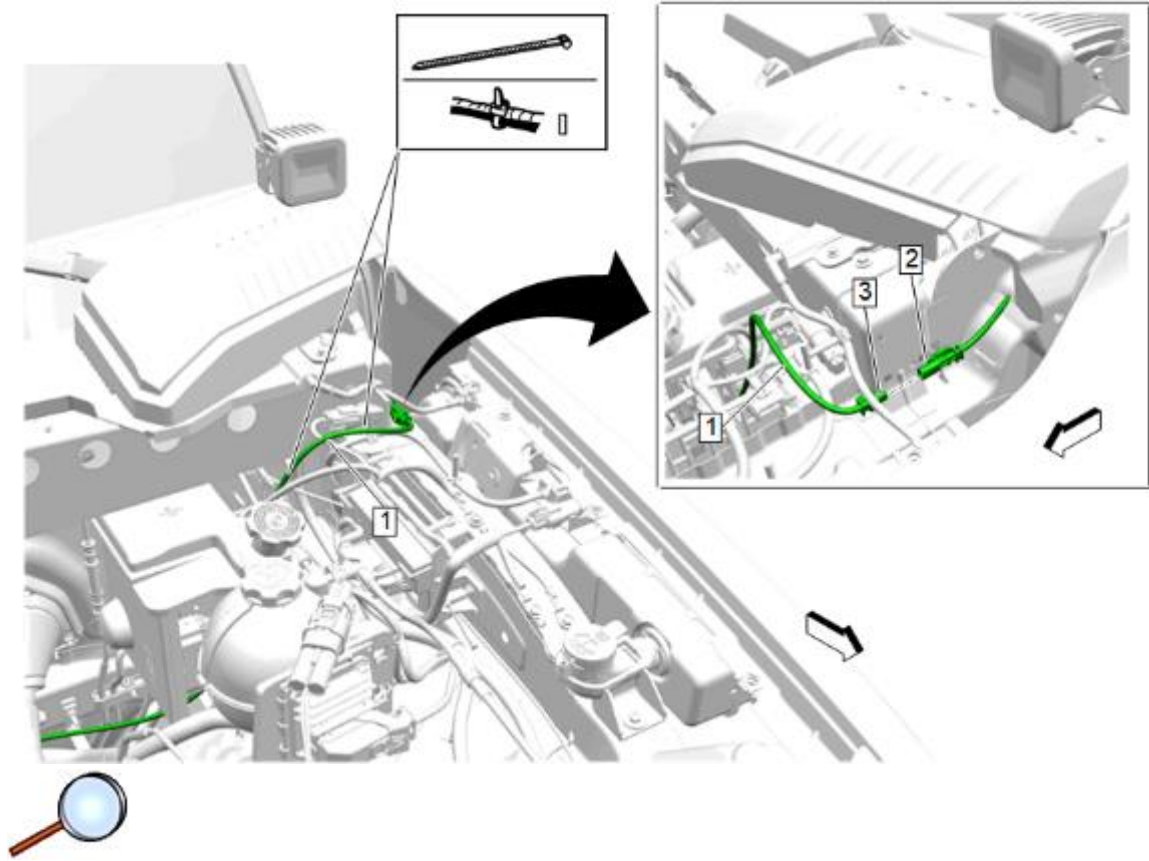

Note: Make sure harness is out of the way of any moving parts or sharp objects.

22. Continue to route remainder of harness (1) under the brake lines and fluid reservoir. Secure harness with tie straps to existing harness as shown. Trim excess of tie straps.
23. Connect lamp pigtail connector (2) to the main harness connector (3). Tie strap them so they are secure. Trim excess of tie straps.

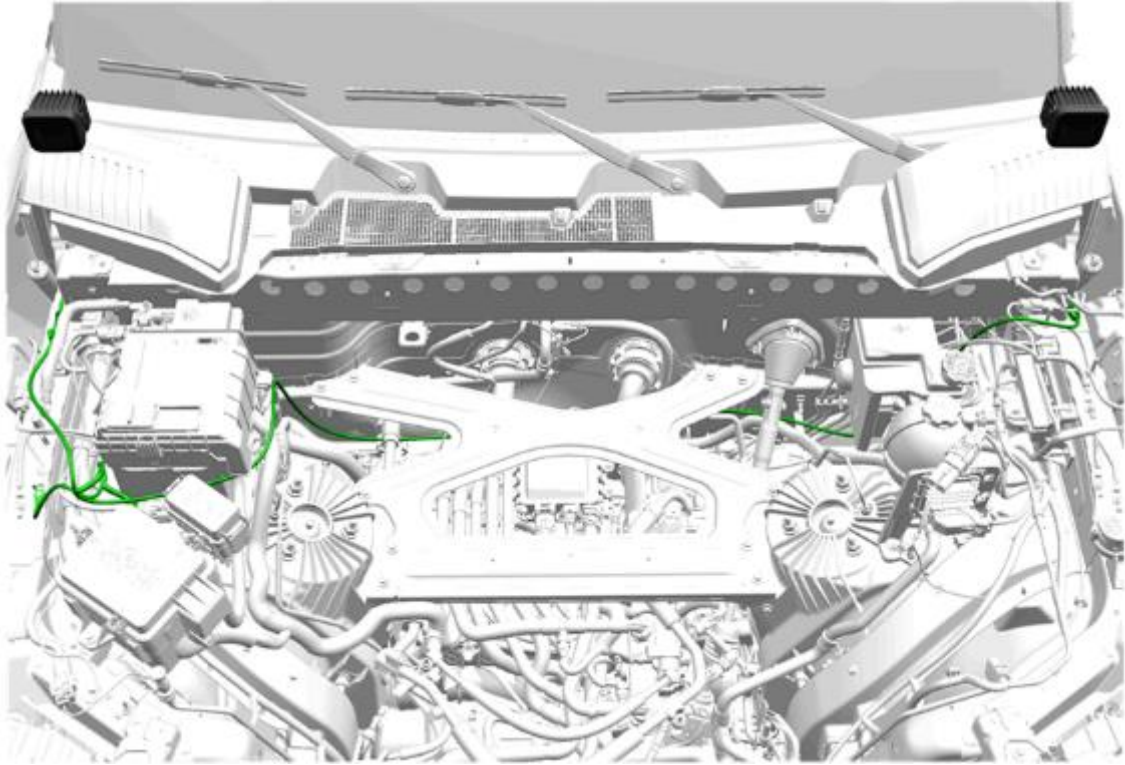

24. Spot lamp install complete.

25. Connect the 12 volt negative battery cable. Refer to [Battery Negative Cable Disconnection and Connection](#) in Vehicle Service Manual.

Virtual Switch Information and Lamp Function

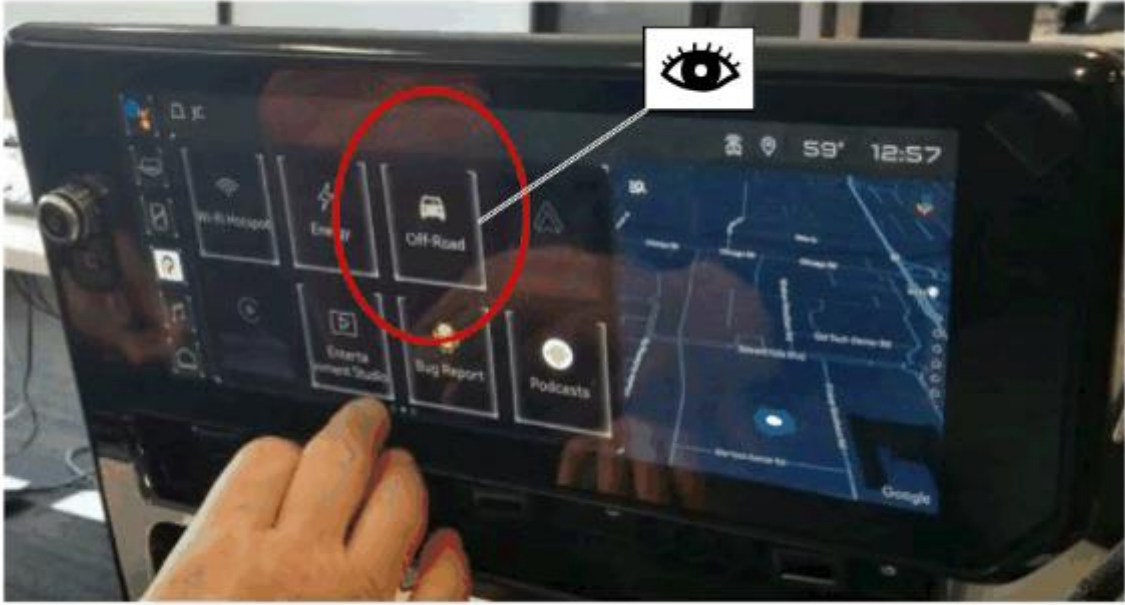

1. On the main menu, select "OFF-Road" app to access.



2. Inside the Off-Road app, press the AUX feature (top image) to access the screen switches (bottom image).



3. Press the edit feature (top image) to allow personalization of text name (bottom image).
4. Place vehicle in Run, verify lamp is working properly.
5. Reinstall the front trim finish compartment and previously removed components. Refer to [Front Trim Finish Compartment Replacement](#) in Vehicle Service Manual.

Power Distribution Box In-line 8-Way Connector

Connector Pin-Out	Wire Color	Relay Position	Fuse Position	Touch Screen Switch
1	Red/Yellow	Relay 1	Fuse 1	1
2	Red/Blue	Relay 2	Fuse 2	2
3	Red/Gray	Relay 3	Fuse 3	3
4	Red	Relay 4	Fuse 4	4
5	Red/White	Relay 5	Fuse 5	5
6	Red/Brown	Relay 6	Fuse 6	6
7	NC	NC	NC	NA
8	NC	NC	NC	NA