



VERTICAL TIRE MOUNT

2015+ CHEVY COLORADO

PLEASE READ ENTIRELY BEFORE YOU START

To guarantee a quality installation, we recommend reading these instructions thoroughly before beginning any work. These instructions assume a certain amount of mechanical ability and are not written nor intended for someone not familiar with auto repair.

TABLE OF CONTENTS

- I. Setting up Vertical Tire Mount
- II. Installation
- III. Mounting Tire
- IV. Tips for use with Bed Caps, Toppers, Etc.

REQUIRED TOOLS

- Common Hand Tools
- Drill
- 1/2" Drill Bit
- 5/16" Drill Bit
- Center Punch
- Deburring Tool
- Rust Preventative such as Permatex Rust Treatment

AEV30418AA

Last Updated: 08/18/20



VERTICAL TIRE MOUNT

2015+ CHEVY COLORADO

| ITEM | PART NO. | DESCRIPTION | QTY |
|------|-------------|---------------------------|-----|
| 1 | ACPR1034AA | TIRE CARRIER | 1 |
| 2 | ACPR1033AA | TIRE MOUNT | 1 |
| 3 | ACPR1020AA | BULKHEAD BRACKET | 1 |
| 4 | ACPR1021AA | SPACER | 2 |
| 5 | ACPR1037AA | BACKER PLATE | 5 |
| 6 | AEV93002AB | M10 FLANGE NUT | 9 |
| 7 | 98930A217 | M10 X 35 CARRIAGE BOLT | 5 |
| 8 | B-98930A219 | M10 X 40 CARRIAGE BOLT | 4 |
| 9 | AEV91055AA | M6 X 20 BUTTON HEAD SCREW | 8 |

| ITEM | PART NO. | DESCRIPTION | QTY |
|------|----------------|-------------------------|-----|
| 10 | ACPR0111AA | J-BOLT NUT PLATE (LH) | 1 |
| 11 | ACPRO113AA | J-BOLT NUT PLATE (RH) | 1 |
| 12 | ACPR1038AA | RIGHT BED REINFORCEMENT | 1 |
| 13 | ACPR0112AA | WELD-NUT PLATE | 2 |
| 14 | ACPR1029AA | MOLDED SPACER | 1 |
| 15 | ACPR1035AA | HANDLE | 1 |
| 16 | CCF-1 1/2-8-12 | END CAP | 2 |
| 17 | AEV98027AA | M6 FLAT WASHER | 8 |
| 18 | AEV93037AA | RETAINING WASHER | 7 |

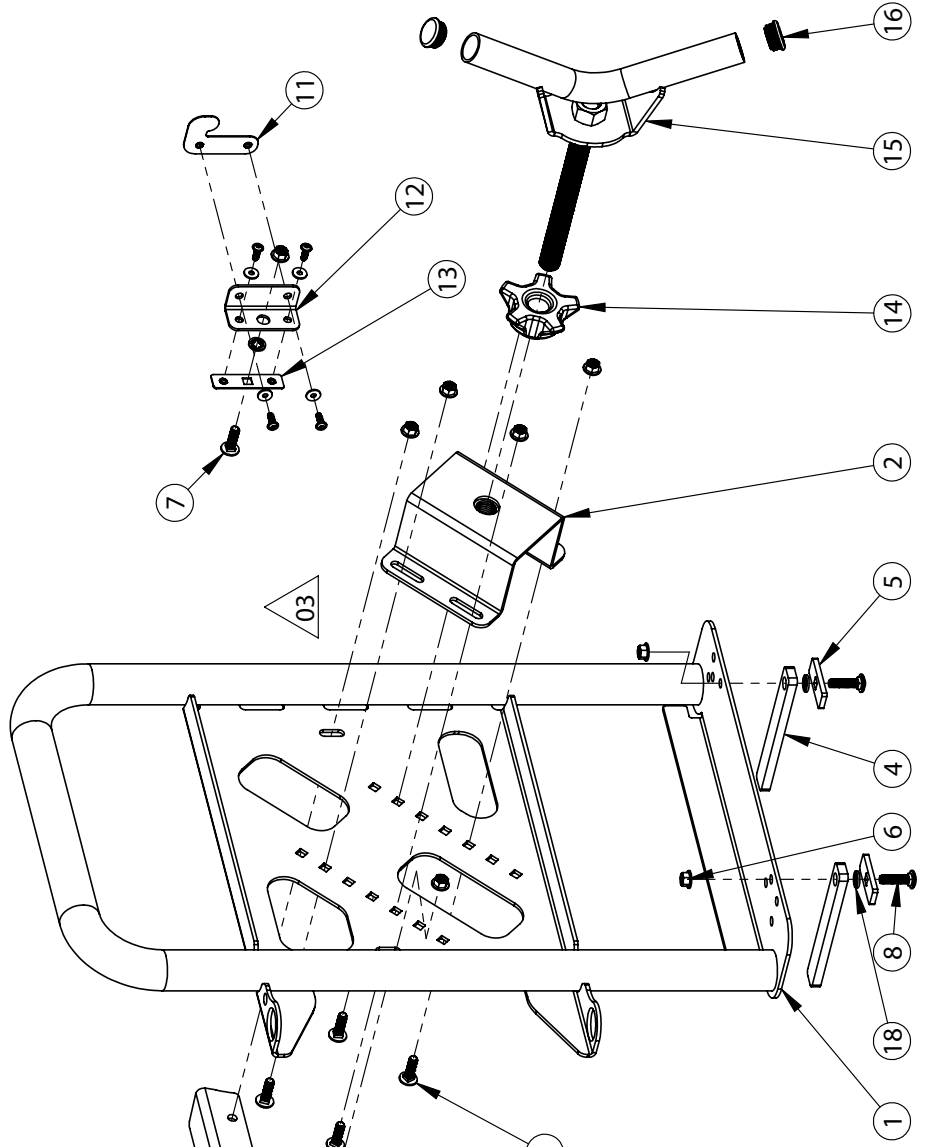



I. SETTING UP VERTICAL TIRE MOUNT

1. Physically measure the diameter of the tire you are using. DO NOT go off the advertised size listed on the sidewall (fig. 1) ex: *37 x 12.50 Tire measures 36"*.
 - A. Divide the diameter measurement in half to calculate the radius ex: $36 \frac{1}{2}'' = 18''$.
 - B. Subtract $\frac{1}{4}''$ from the radius to account for material thickness of the Tire Carrier ex: $18'' - \frac{1}{4}'' = 17 \frac{3}{4}''$

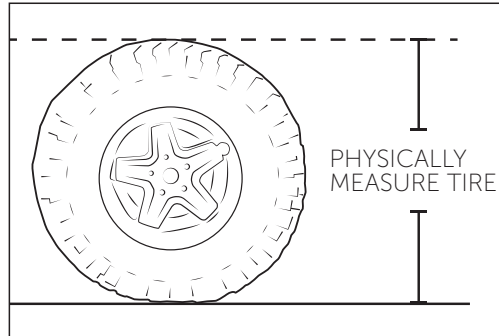

Figure 1

2. Use the final dimension from 1-B to position the Tire Mount on the Tire Carrier (fig. 2).

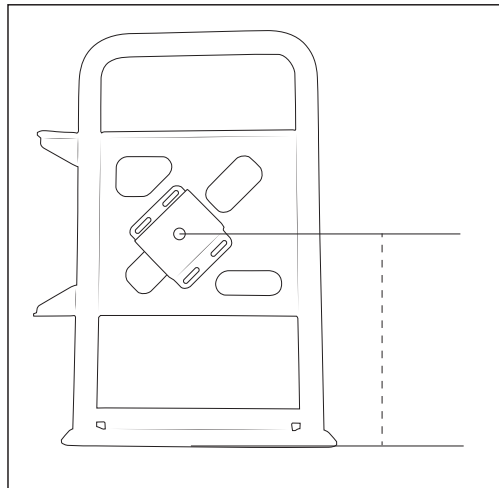

Figure 2

3. Install four M10x35 carriage bolts through the back side of the Tire Carrier. Secure with M10 nuts and tighten until snug. Some adjustment may be required, nuts will be torqued later



II. INSTALLATION

1. Remove bedside plastic covers by prying upward (fig. 3).

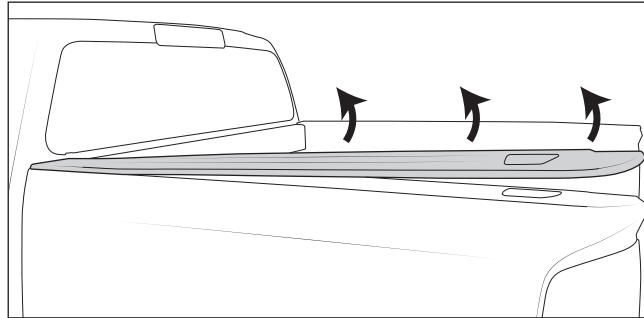

Figure 3

2. Position the Bulkhead Bracket (LH) and Right Bed Reinforcement (RH), mark all holes to be drilled (fig. 4).
3. Center punch and drill eight 5/16" holes and five 1/2" holes for the larger bolts. NOTE: The top hole is optional when installing with a bed cap topper.
4. Deburr and prep bare metal with rust preventative.

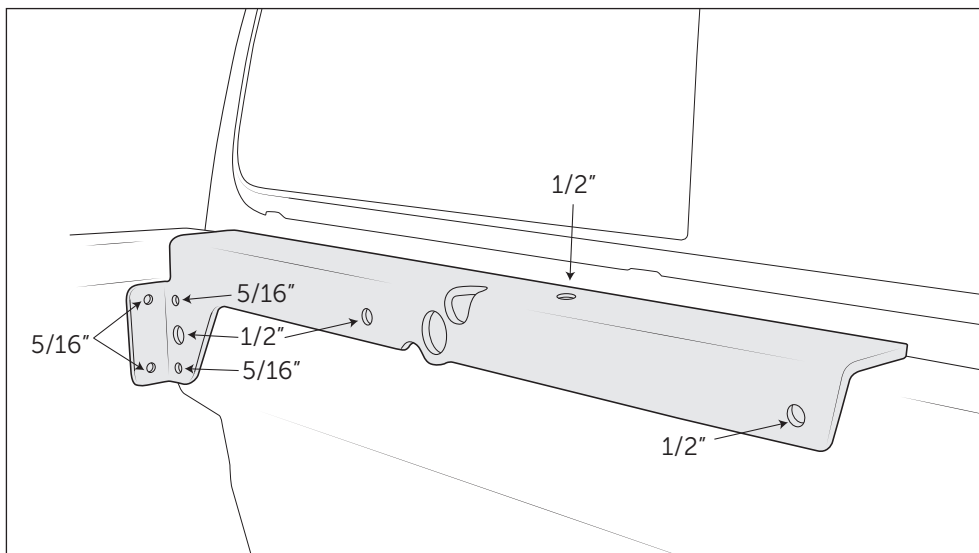

Figure 4: LH side

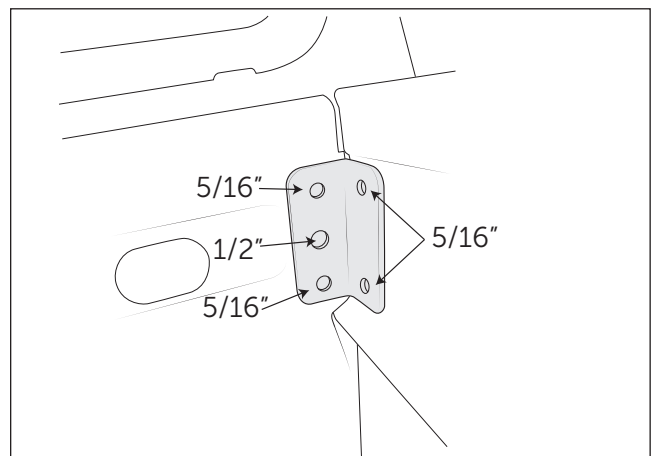
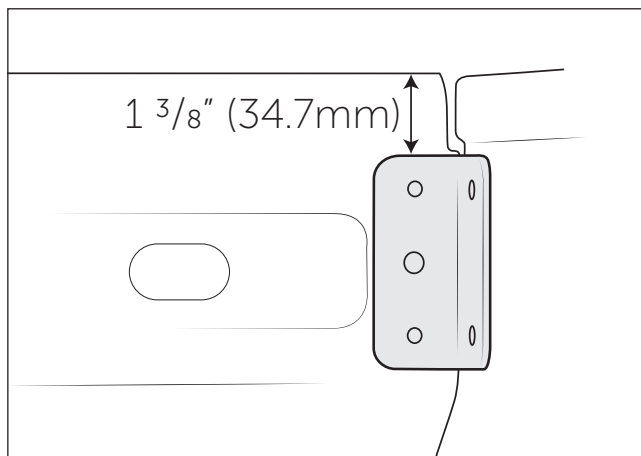

Figure 4: RH side



5. Install Bulkhead Bracket and Right Bed Reinforcement.

- A. Thread provided fish wire onto M10x35 carriage bolts with weld-nut plates and fish through holes. Hold in place with retaining washers (fig. 5).

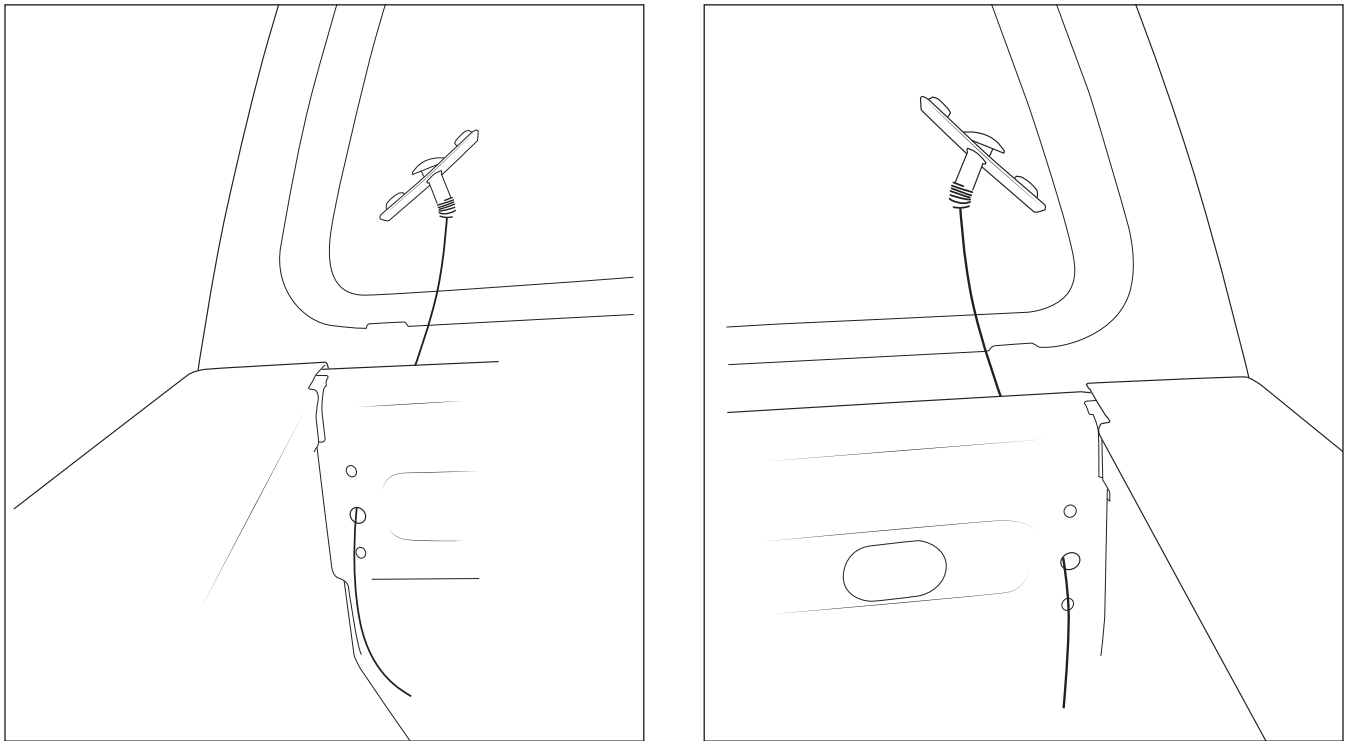

Figure 5

- B. Drop the J Bolt Nut Plates into stake pockets at the front of each bedside (fig. 6).

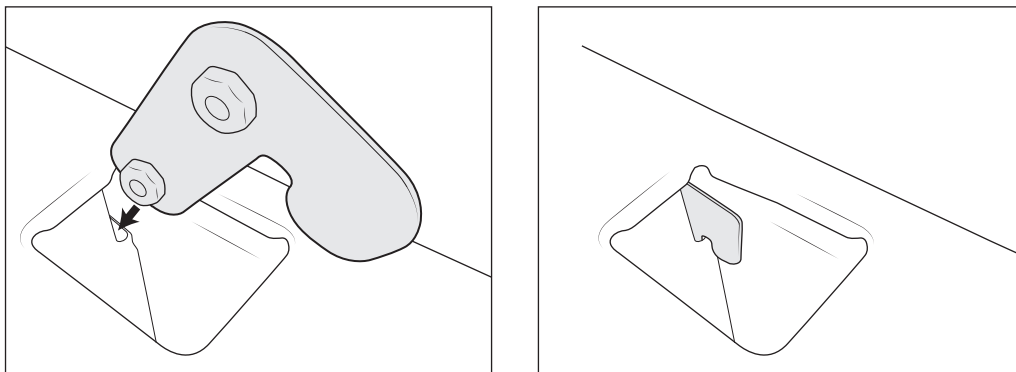

Figure 6

- C. Install the Bulkhead Bracket and Right Bed Reinforcement over the M10 bolts.
- D. Start all four (per side) M6x20 button head screws with washers.
- E. Install two M10 nuts on the M10x35 carriage bolts and torque to 46 lb-ft.
- F. Reinstall plastic bedside covers.



- G. Use the fish wire to pull one M10x35 carriage bolt and backer plate through upper Bulkhead Bracket hole (fig. 7). Torque to 46 lb-ft.

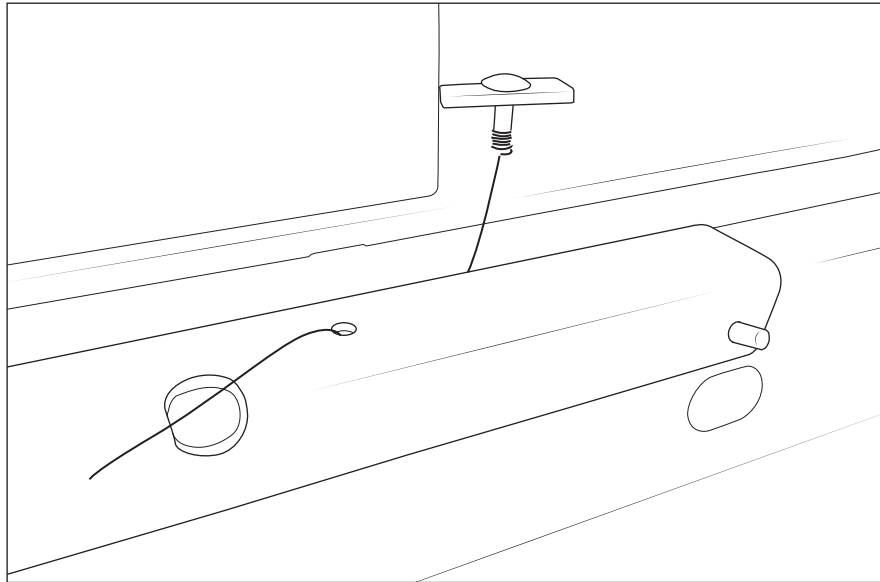

Figure 7

- H. Tighten M6 screws at corners to 7 lb-ft.
6. Position Tire Carrier in vehicle bed.
- A. Slide the two provided Spacers under mount to fill space between bottom of bed and mount.
NOTE: The Spacers should be pushed all the way forward, this will locate the Tire Carrier position front to back (fig. 8).

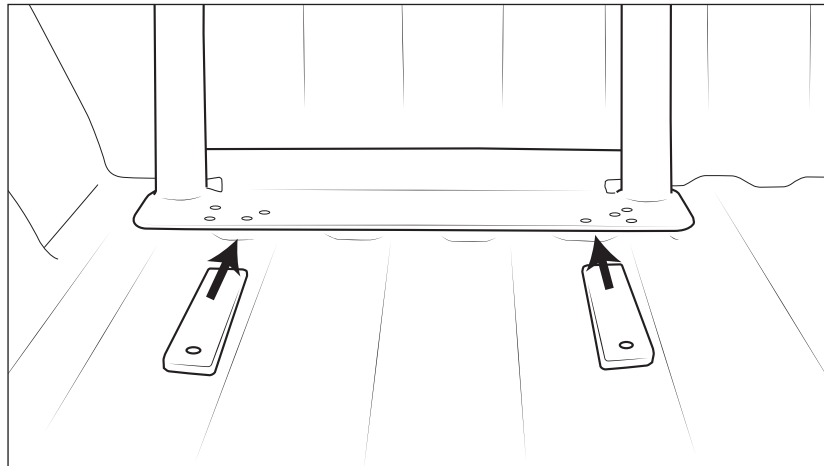

Figure 8



- B. Mark two hole locations on the bed floor (fig. 9).

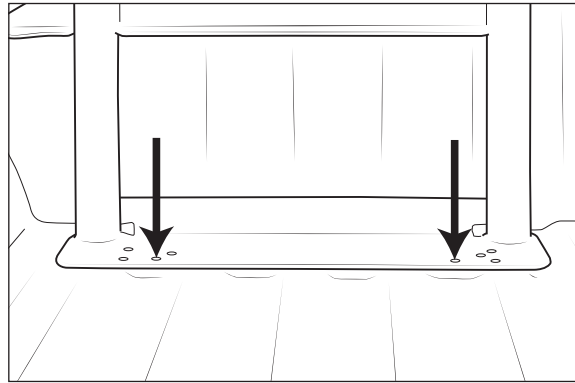

Figure 9

- C. Remove Tire Carrier. Center punch and drill two 1/2" holes.
NOTE: Be careful not to drill too far down (gas tank is below).

- D. Deburr and prep bare metal with rust preventative.

7. Install Tire Carrier

- A. Using the supplied fish wire pull two M10x40 carriage bolts and backer plates (with shank) through the bed, Bulkhead Bracket, and Tire Carrier. Start nuts but do not torque.
- B. Use the fish wire push down through Tire Carrier, Spacers, and bed floor. Pull through two M10x40 carriage bolts with backer plates from under vehicle. NOTE: If working alone it helps to set bolt and nut-plate onto gas tank. Hold in place with retaining washers.
- C. Secure with M10 flange nuts. Torque all nuts to 46 lb-ft.

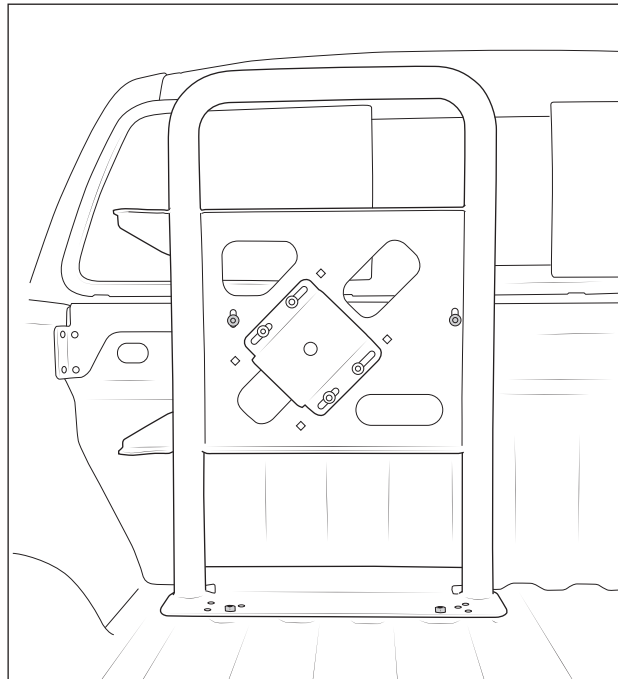

Figure 10



III. MOUNTING TIRE

1. Slide molded spacer onto threaded portion of handle (fig. 12).
2. Install 1 1/2" end caps on to handle (fig. 12).

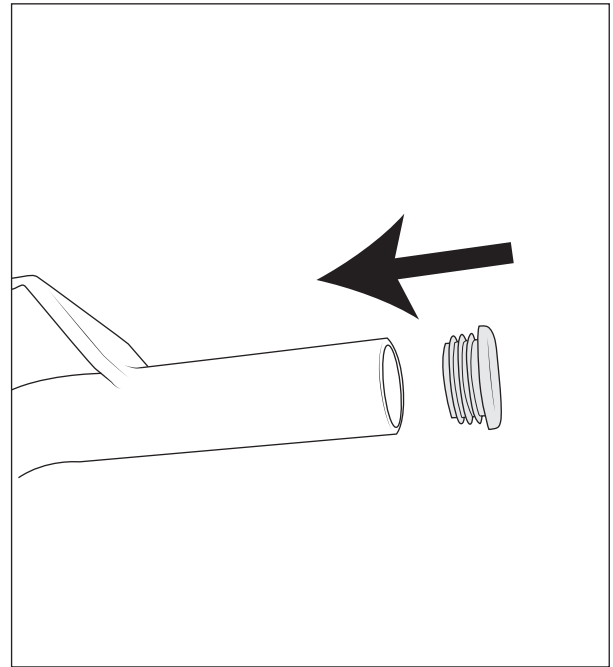
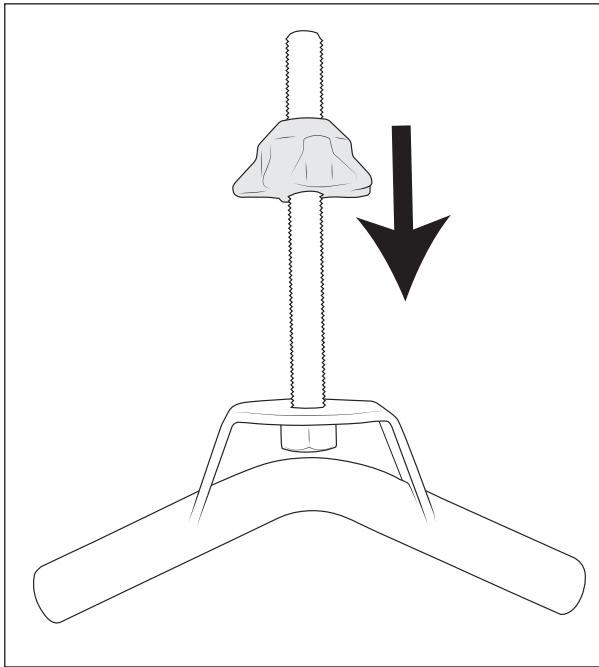

Figure 12

3. Insert handle with molded spacer through spare tire and thread into the Tire Mount.
4. Check to ensure the spare tire is resting on the bed of the truck **DO NOT LET THE TIRE HANG IN THE AIR**. If necessary adjust the Tire Mount to sit lower on the Tire Carrier (See Section I).
5. When you have confirmed the Tire Mount is in the proper position, torque nuts to 43 lb-ft.
6. Mount the spare tire and tighten down the handle.



IV. TIPS FOR INSTALLING WITH A BED CAPS, TOPPERS, ETC.

NOTE: Installation may vary between brands and styles. An ARE brand bed topper was used for the purpose of these instructions and this is only meant as a guide for possible installation with other equipment.

1. Install the Vertical Tire Mount (VTM) per instructions with the elimination of the single vertical bolt through the Bulkhead Bracket, or remove this bolt if previously installed.
2. Remove the VTM leaving all of the M10 bolts in place (hold with retaining washers).
3. Install the bed cap, topper, etc.
4. If the bed cap has a fiberglass flange on the bulkhead that reaches into the bed area it will need to be trimmed (fig. 13). Place the VTM's Bulkhead Bracket into position and mark where the fiberglass flange needs to be cut.

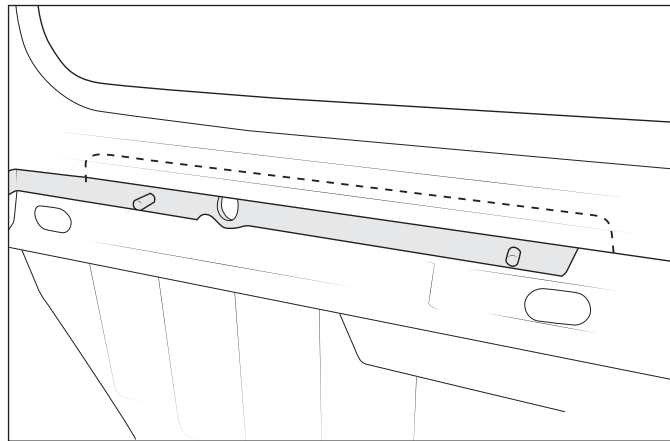

Figure 13

5. Gently peel back the carpet (if equipped) and trim the fiberglass flange so the VTM can be installed as designed. Glue carpet into new position and trim as necessary.
6. Install VTM per instructions.
7. The spare tire must sit flush against the bedside. Temporarily place tire into position and mark the inside flange of the bed cap where the tire makes contact (fig. 14).

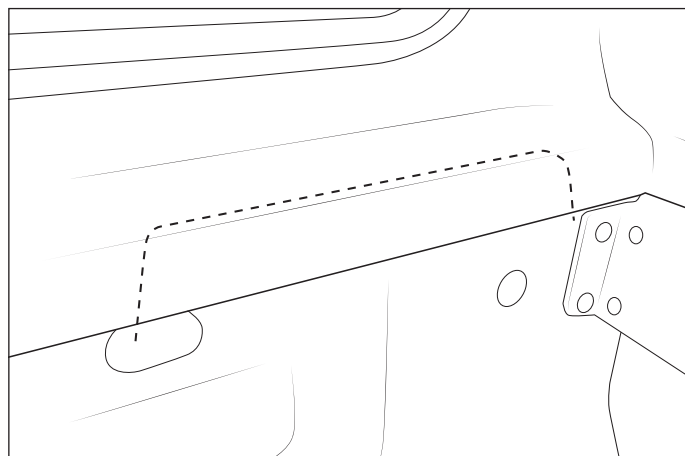

Figure 14

8. Trim the fiberglass flange as in step 5.