

Pickup Box Ornamentation Bar Package Installation

Installation Instructions Part Number

84219049

© 2024 General Motors. All rights reserved.

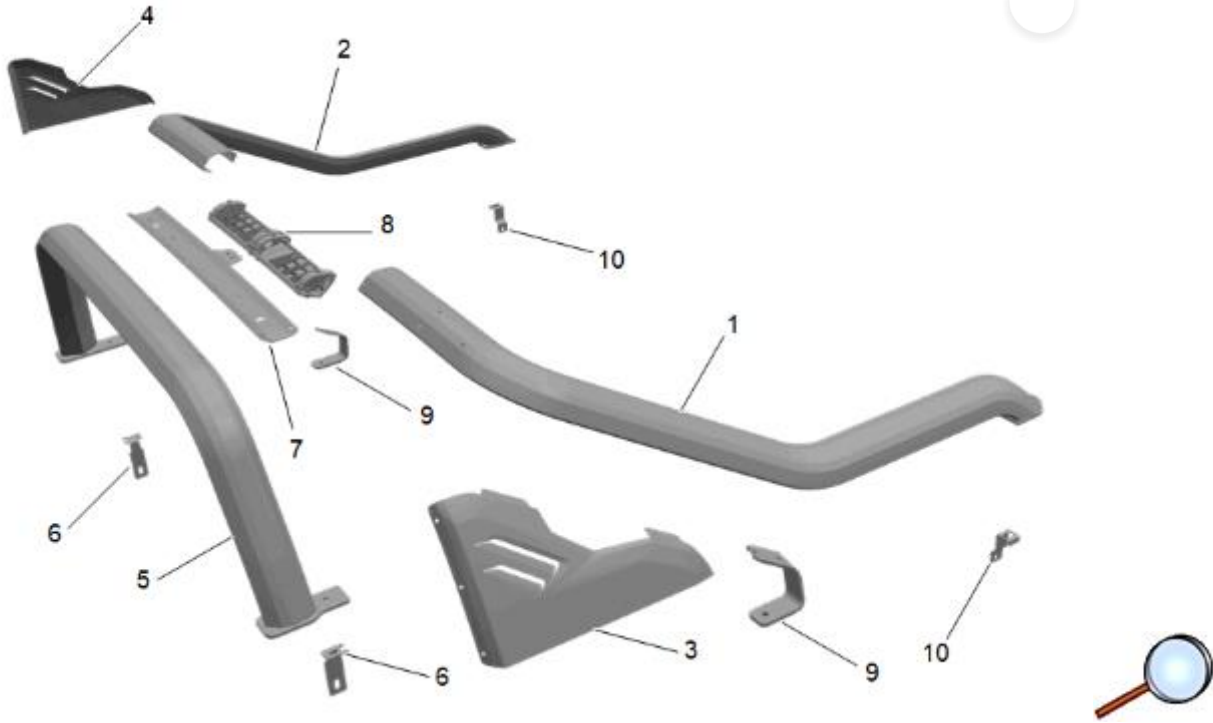

Kit Contents

Item	Qty	Description
1	1	Rear Tube – LH
2	1	Rear Tube – RH
3	1	Side Deco Plate – LH
4	1	Side Deco Plate – RH
5	1	Front Tube
6	2	Front Stake Pocket Bracket
7	1	Light Plate
8	1	Tube Connector
9	2	Mid Support Bracket

Item	Qty	Description
10	2	Rear Stake Pocket Bracket
—	1	Fastener/Hardware Package
-	1	Installation Instructions

Tools Required

- Ratchet Wrench
- Torque Wrench
- 13mm Socket
- T40 TORX Internal Driver
- Safety Glasses
- Utility Knife
- Drill
- 1/4" Drill Bit
- 1" Hole saw

© 2024 General Motors. All rights reserved.

Installation Procedure

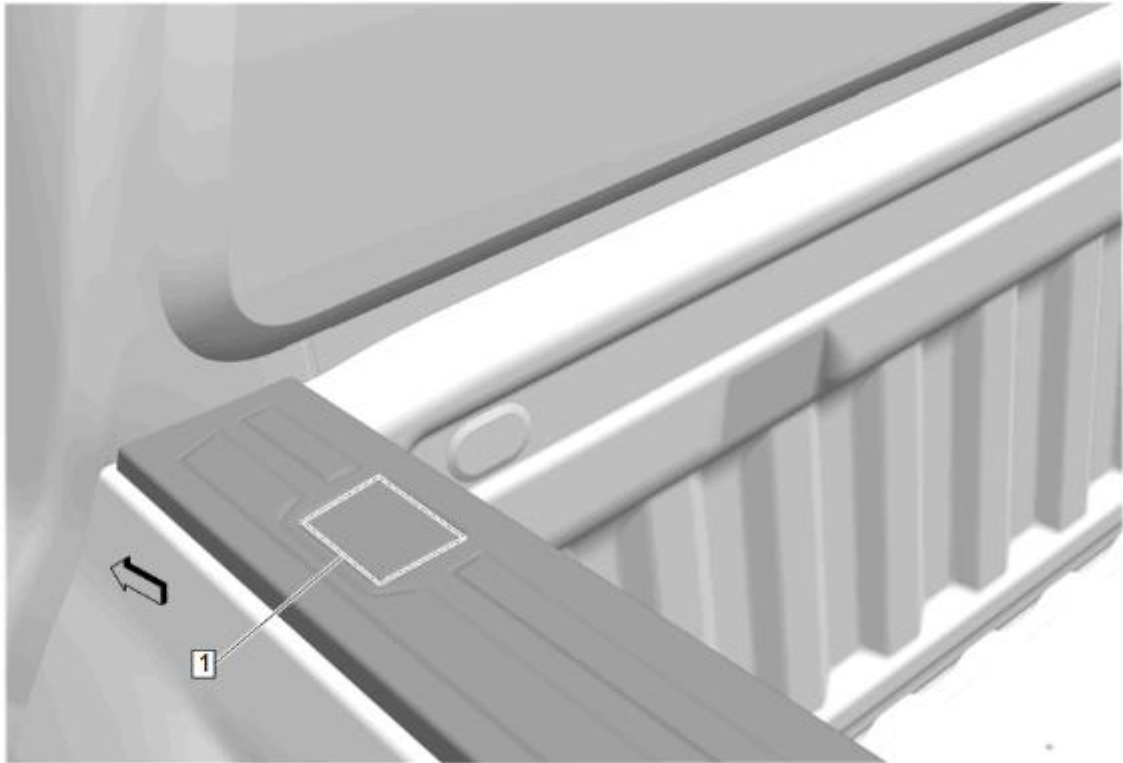

1. Carefully cut the bed rail molding (1) along the rectangular grooves to expose front stake pockets.

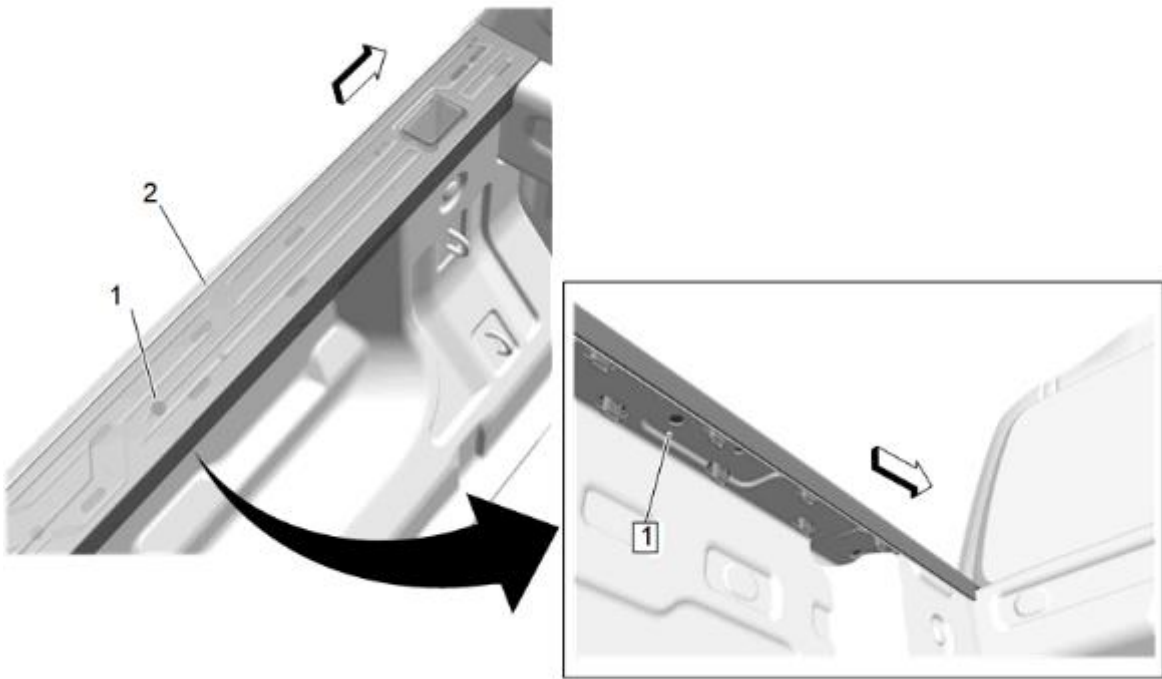

Caution: Always check scale, size and position of holes before drilling. Failing to do so may cause damage to the vehicle, misalignment of components or the inability to install the accessory.

- Carefully cut hole in the left bed rail molding (2) by drilling 1/4" pilot hole (from the underside) using the 1 mm pilot locator (1) on the bed rail moldings, seen through the 10.5 mm hole on the underside of the bed rail. Move to the topside of the bed rail and enlarge the hole in the bed rail molding using the 1" hole saw. Proceed carefully and do not drill through the steel box below.

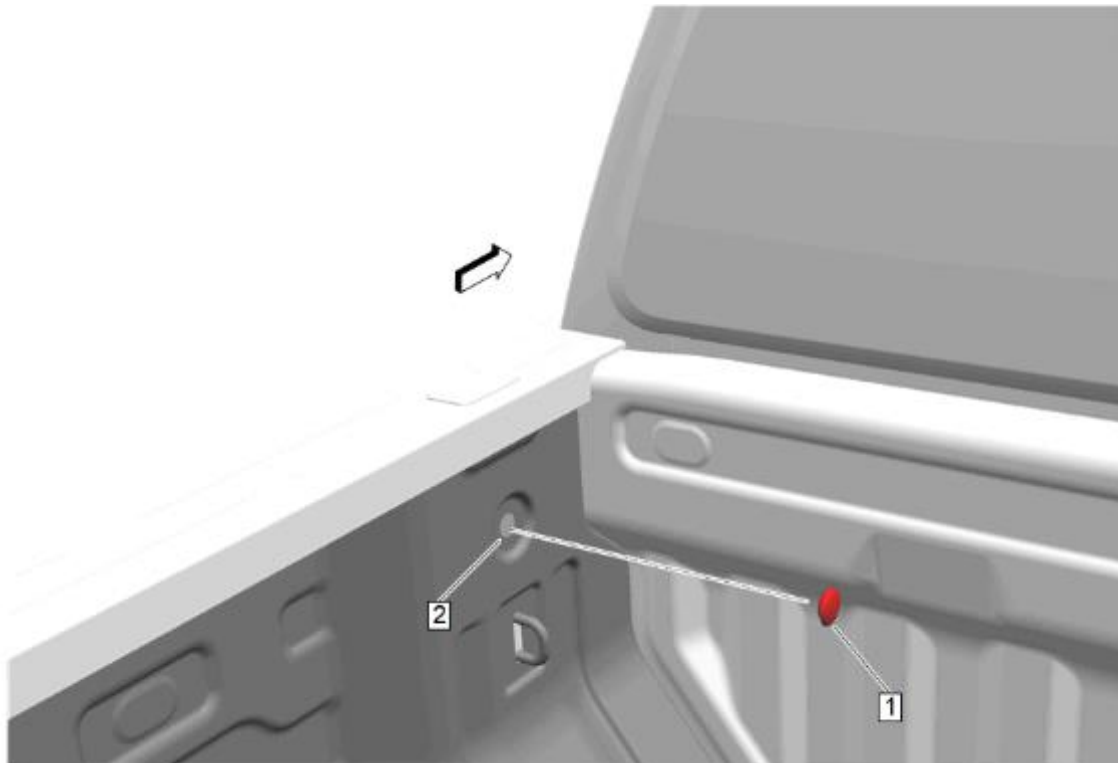

- Remove the front plug (1) from the bedside (2).

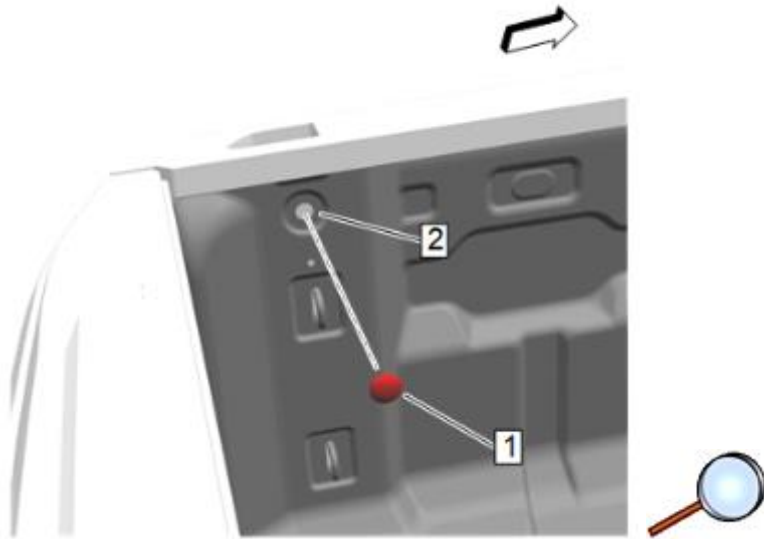

4. Remove the rear plug (1) from the bedside (2).

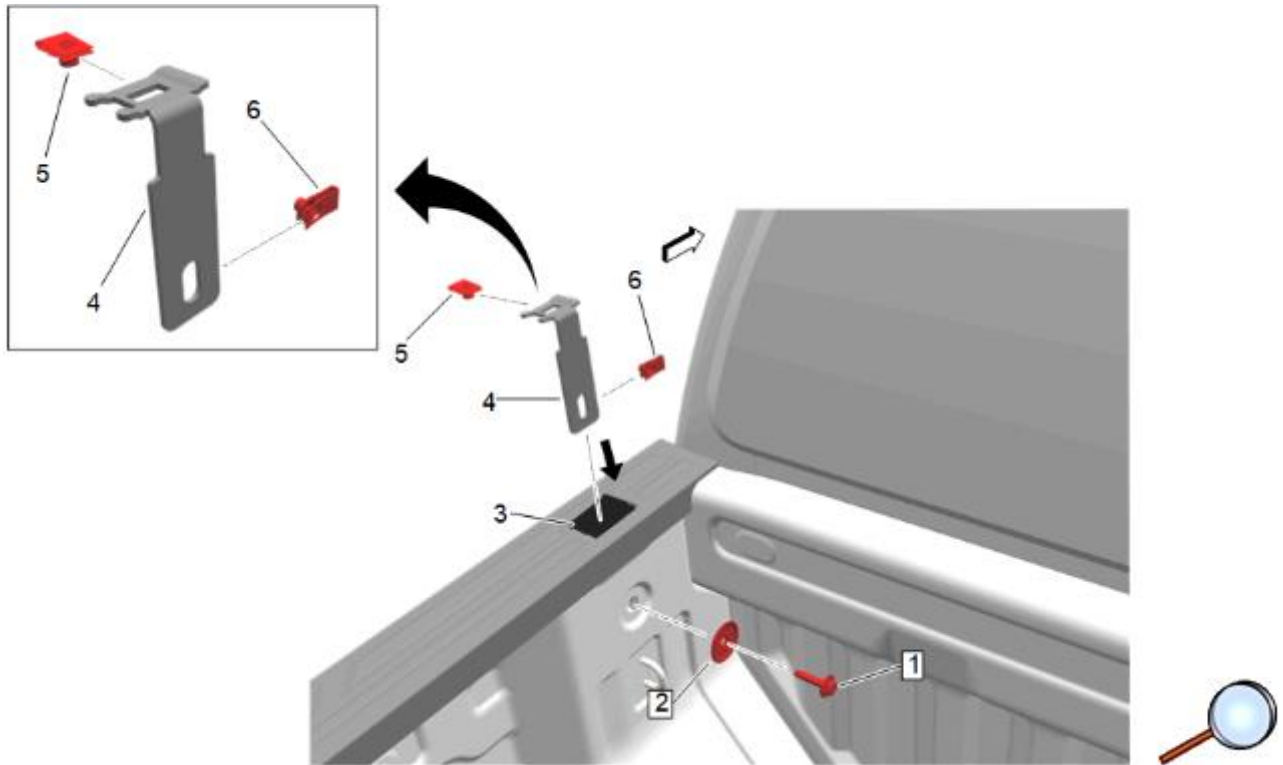

Caution: Use the correct fastener in the correct location. Replacement fasteners must be the correct part number for that application. Fasteners requiring replacement or fasteners requiring the use of thread locking compound or sealant are identified in the service procedure. Do not use paints, lubricants, or corrosion inhibitors on fasteners or fastener joint surfaces unless specified. These coatings affect fastener torque and joint clamping force and may damage the fastener. Use the correct tightening sequence and specifications when installing fasteners in order to avoid damage to parts and systems.

5. Install the J-nuts (5), (6) to the upper and lower parts of the front stake pocket mounting bracket (4). Insert the bracket (4) into the stake pocket (3) and loosely secure bracket with the M8 hex head bolt (1) and large washer (2).
6. Repeat steps 1 through 5 for opposite side.

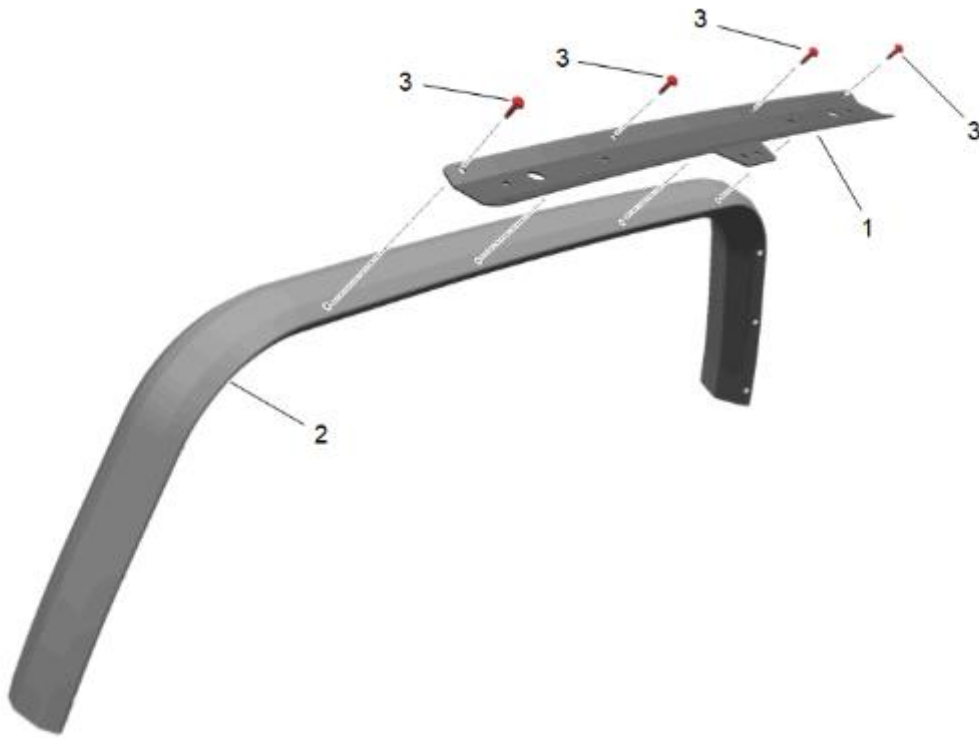

7. Loosely attach the light plate (1) to the front tube (2) using four M6 torx bolts (3).

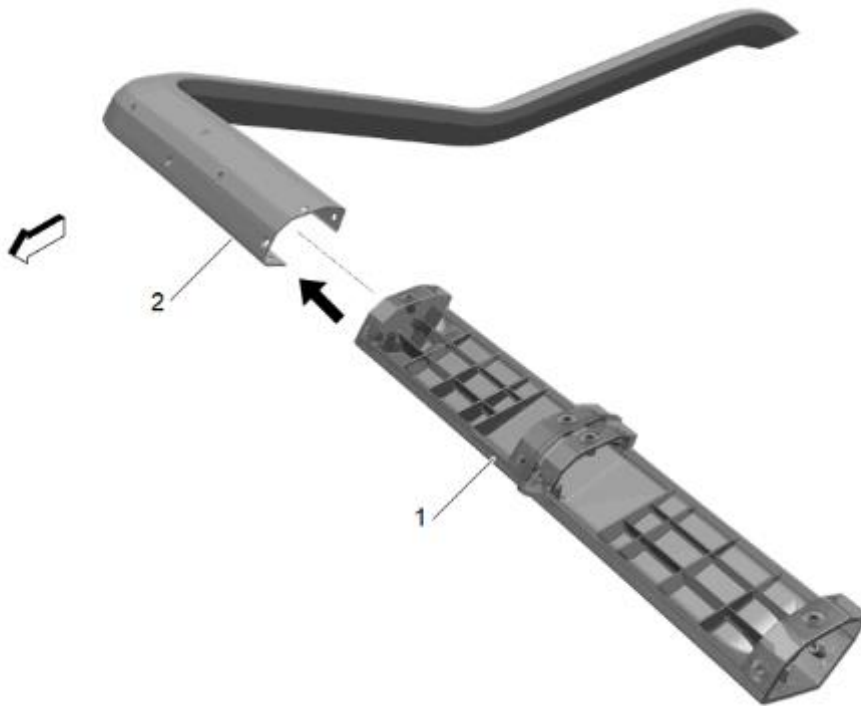

8. Insert the tube connector (1) into the RH rear tube (2).



9. Insert the tube connector (2) into the LH rear tube (1).

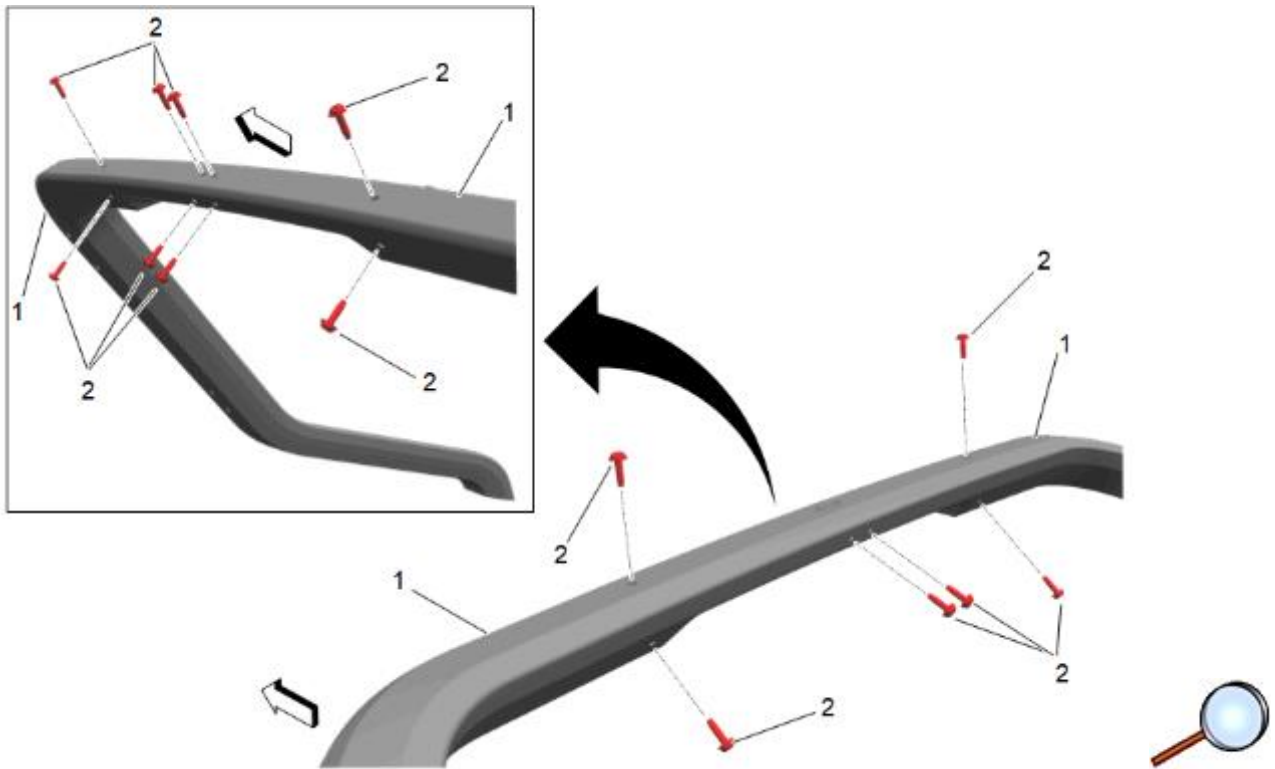

10. Attach the tube connector to both rear tubes (1) using fourteen M6 torx fasteners (2). Tighten the fasteners to 10 ± 1 N.m (7 lb ft).

Note: Hand tighten fasteners only, over torquing could cause damage.

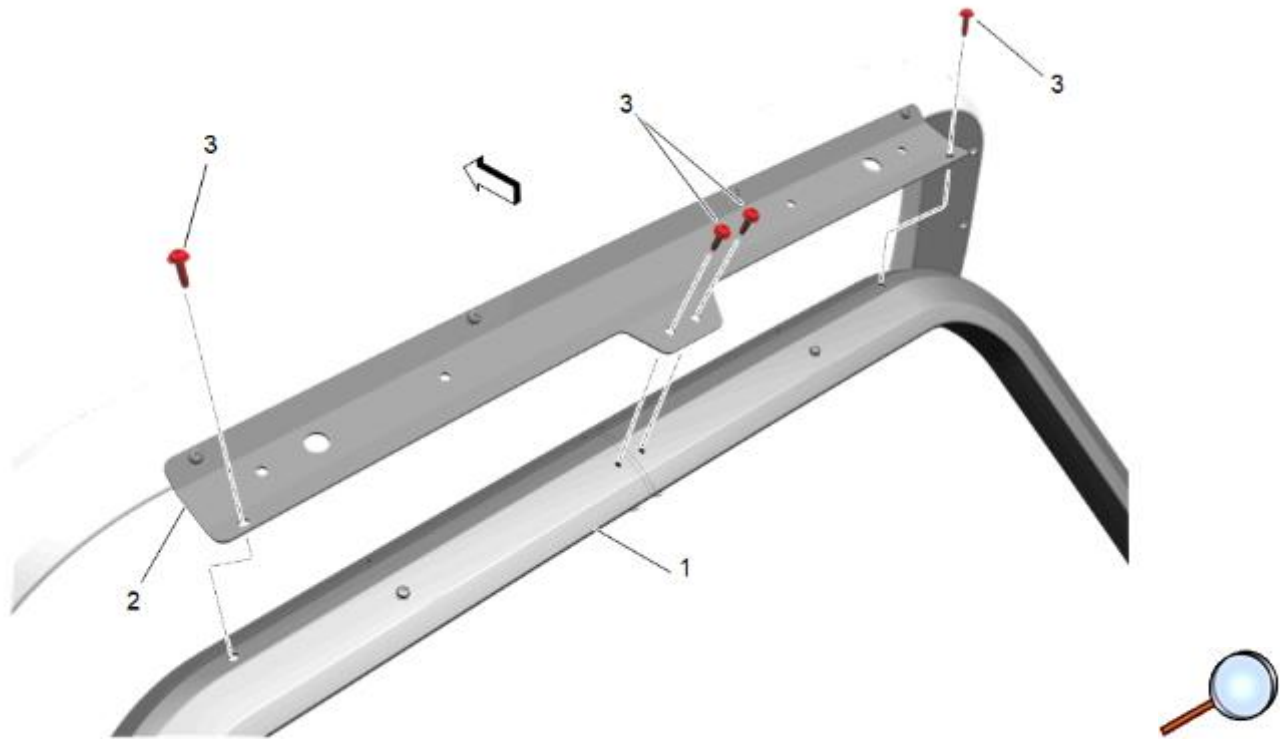

© 2024 General Motors. All rights reserved.

11. Loosely attach the light plate (2) to the rear tube (1) using four M6 torx fasteners (3).

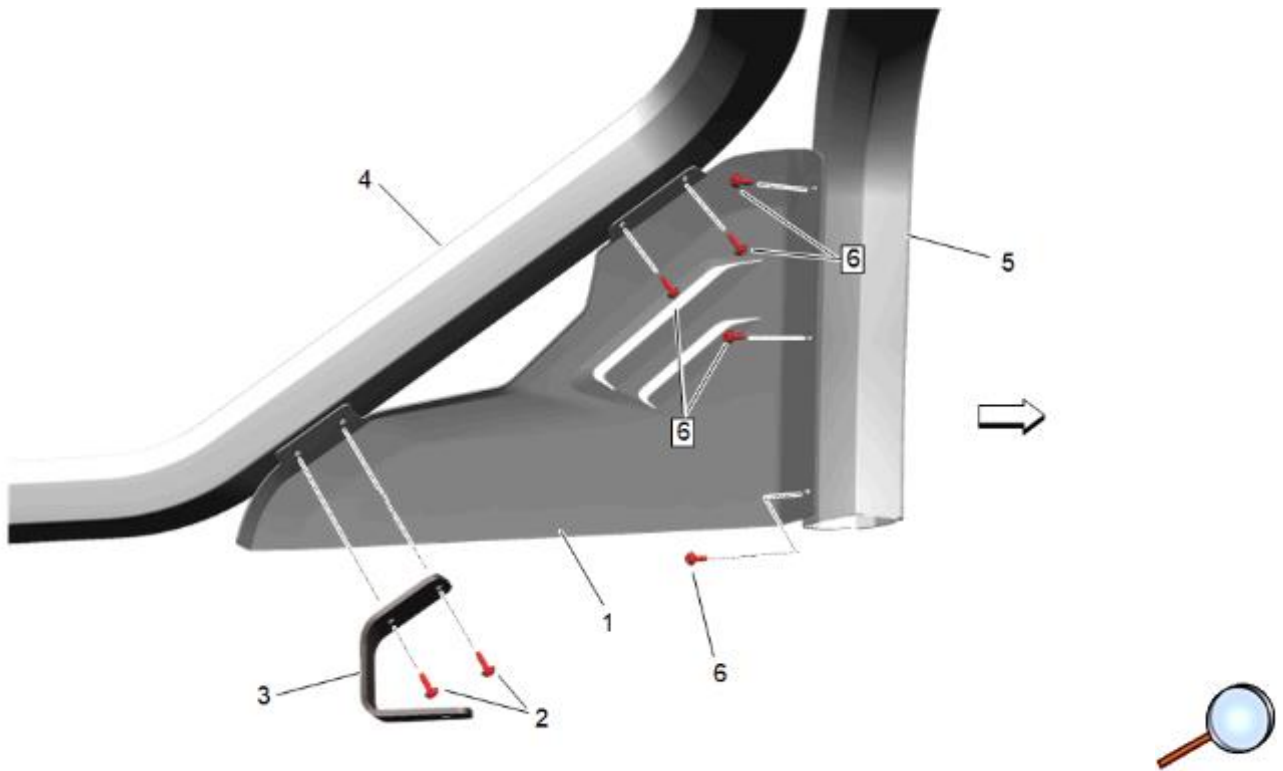

12. Loosely attach the deco plate (1) to the front (5) and rear (4) tubes using five M6 torx fasteners (6).

13. Repeat side deco plate attachment for opposite side.

14. Loosely attach the mid support bracket (2) to the rear tube using two screws (2).

15. Repeat mid bracket support attachment for opposite side.

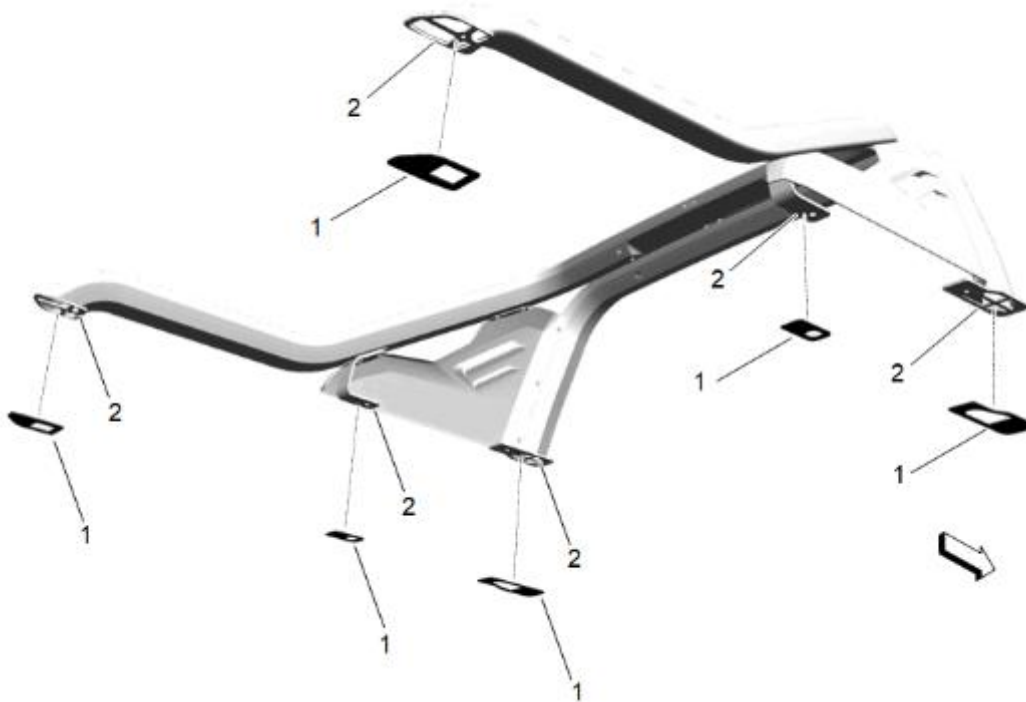

© 2024 General Motors. All rights reserved.

16. Peel off the white adhesive backer and position the foam gaskets (1) to the matching areas on the sport bar assembly (2).
17. Mount any lights (sold separately) at this time to enable wire routing through the front tube without later removing the sport bar. Be sure wiring is routed through proper openings to prevent pinching during installation.

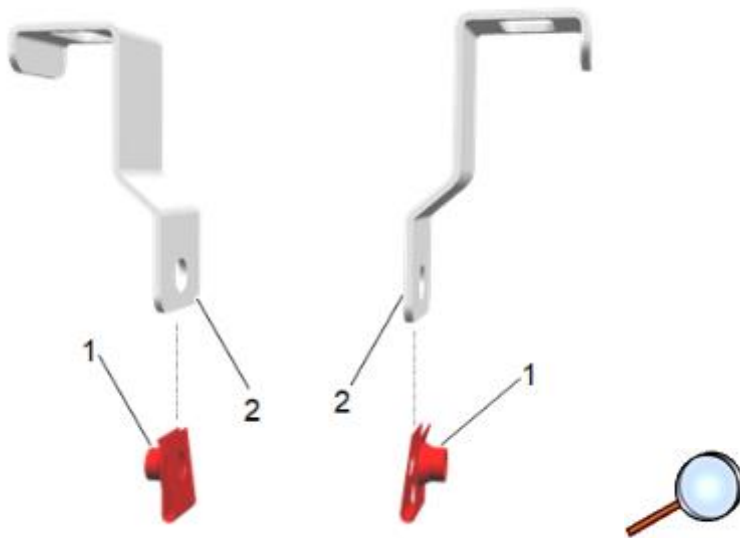

18. Attach J-nuts (1) to the rear stake pocket brackets (2).



19. Attach the rear stake pocket bracket (3) to the rear tube (4) with M8 torx screw (1) and spacer (2). Center the bracket to the tube nut. Tighten the screw to 10 N.m (7 lb ft).

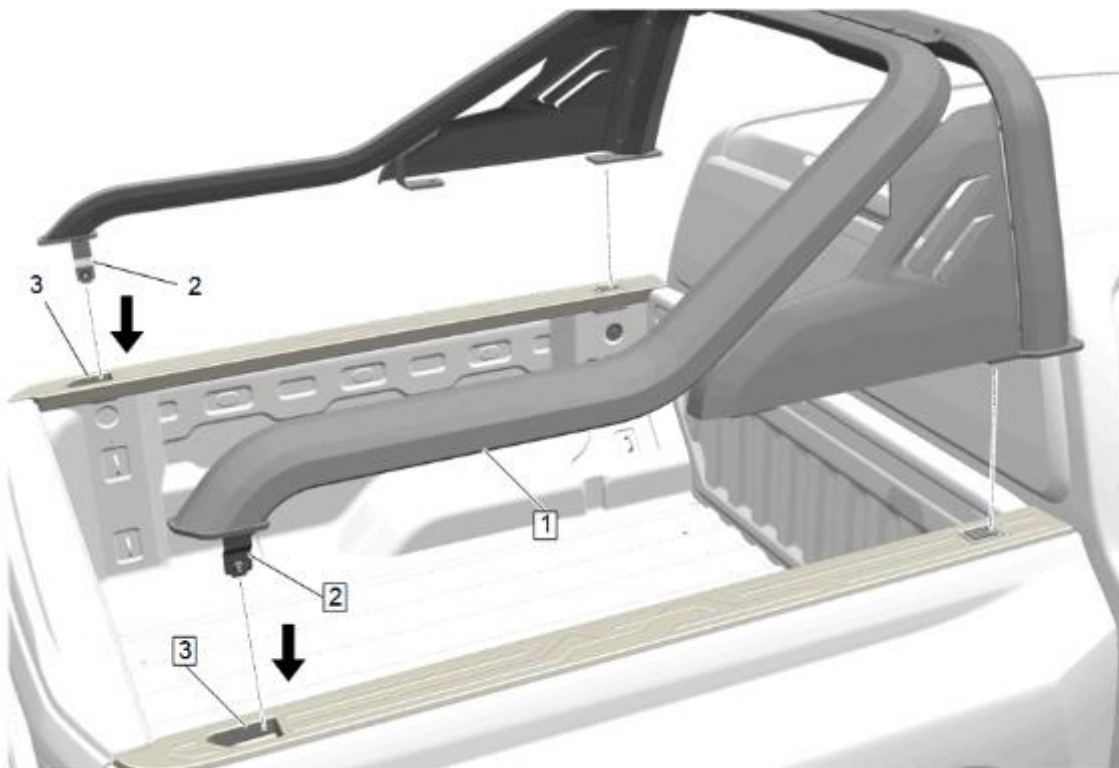

20. With the aid of an assistant, position the rear stake pocket brackets (2) into the rear stake pockets (3) and position the sport bar assembly (1) to the vehicle.

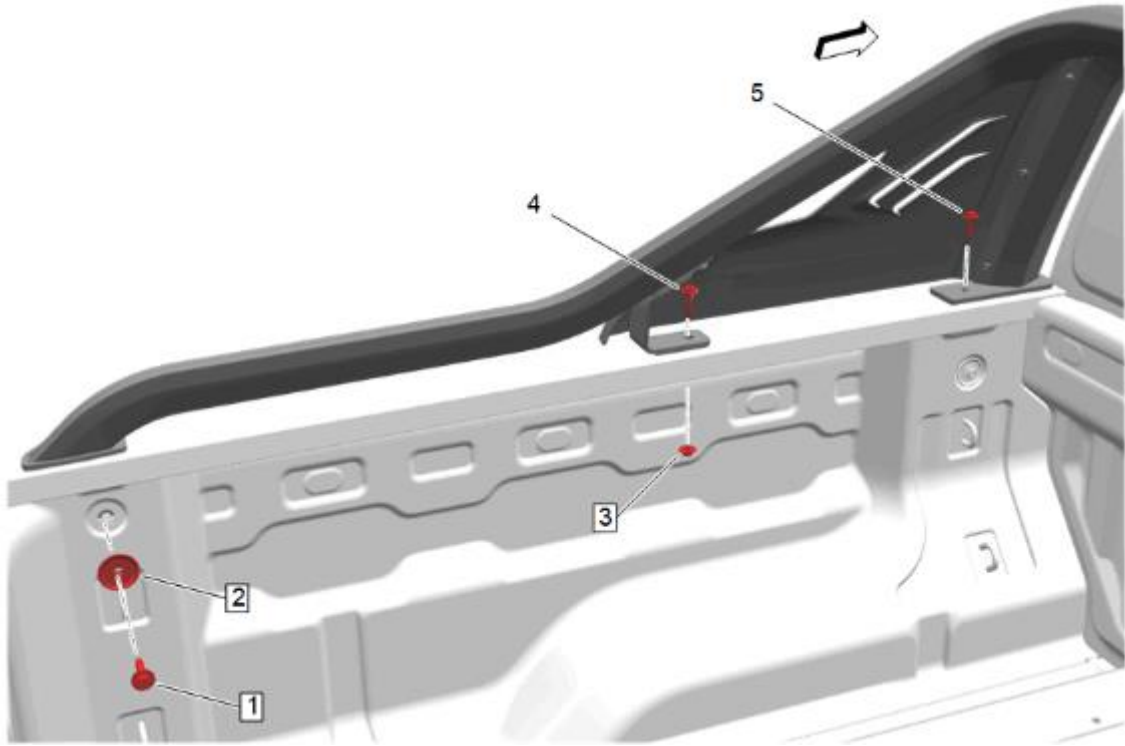

21. Attach front tube to the front stake pocket bracket using M8 hex bolt (5).
22. Loosely attach the mid support bracket using M8 torx bolt (4) and nut (3).
23. Repeat step 21 and 22 for opposite side.
24. Loosely attach rear stake pocket bracket to pickup box with single M8 hex bolt (1) and large washer (2). Repeat for opposite side.

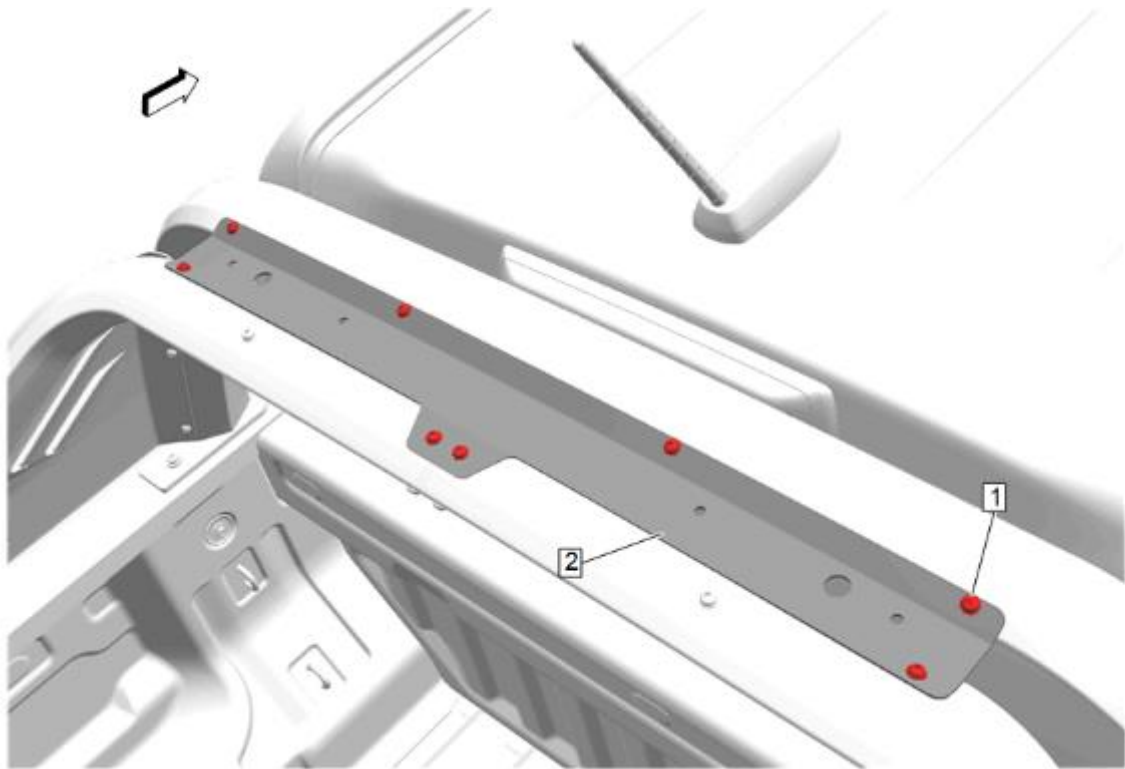

25. Tighten the eight M6 torx screws (1) that secure the top plate to the front and rear tubes to 10 ± 1 N.m (7 lb ft).

Note: Hand tighten fasteners only, over torquing could cause damage.

26. Inspect the fit of the sport bar onto the pickup box to verify that it is evenly positioned side to side and fore/aft.

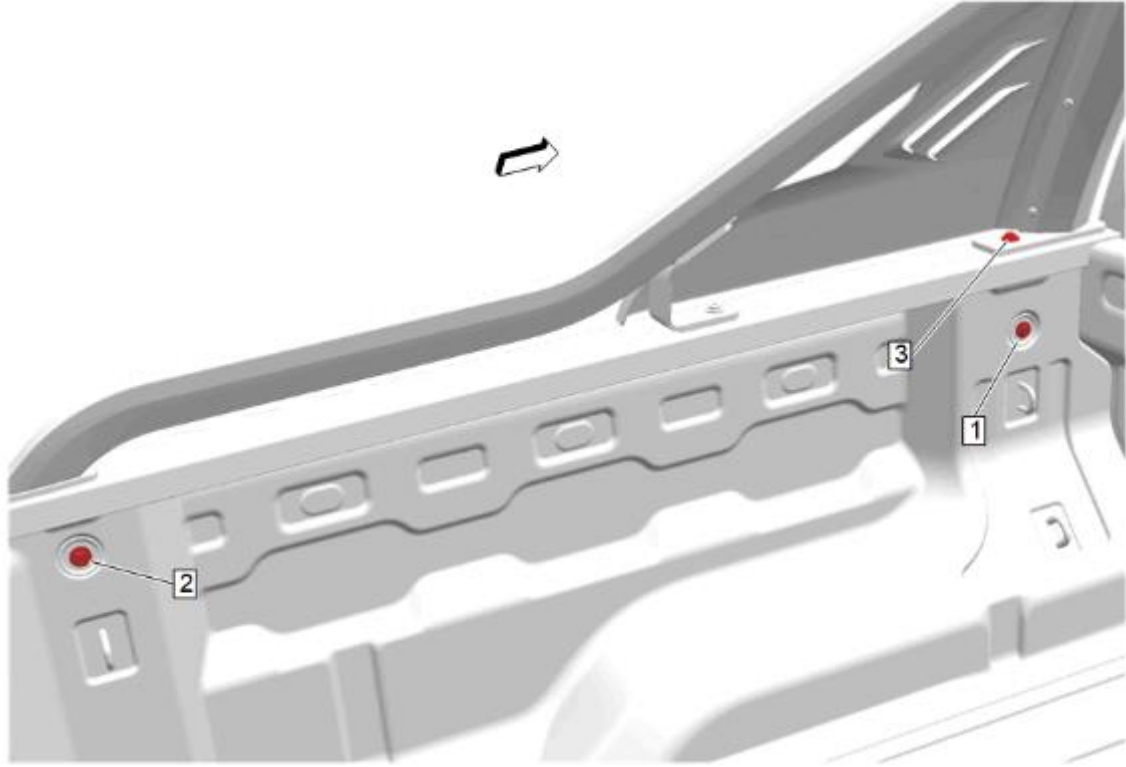

© 2024 General Motors. All rights reserved.

27. On the driver side, tighten the front stake pocket bracket bolt (1) and rear stake pocket bracket bolt (2) to 22 N.m (16 lb ft).

28. Tighten the front upper stake pocket bracket bolt (3) to 10 N.m (7 lb ft).

29. Repeat steps 27 and 28 for opposite side.

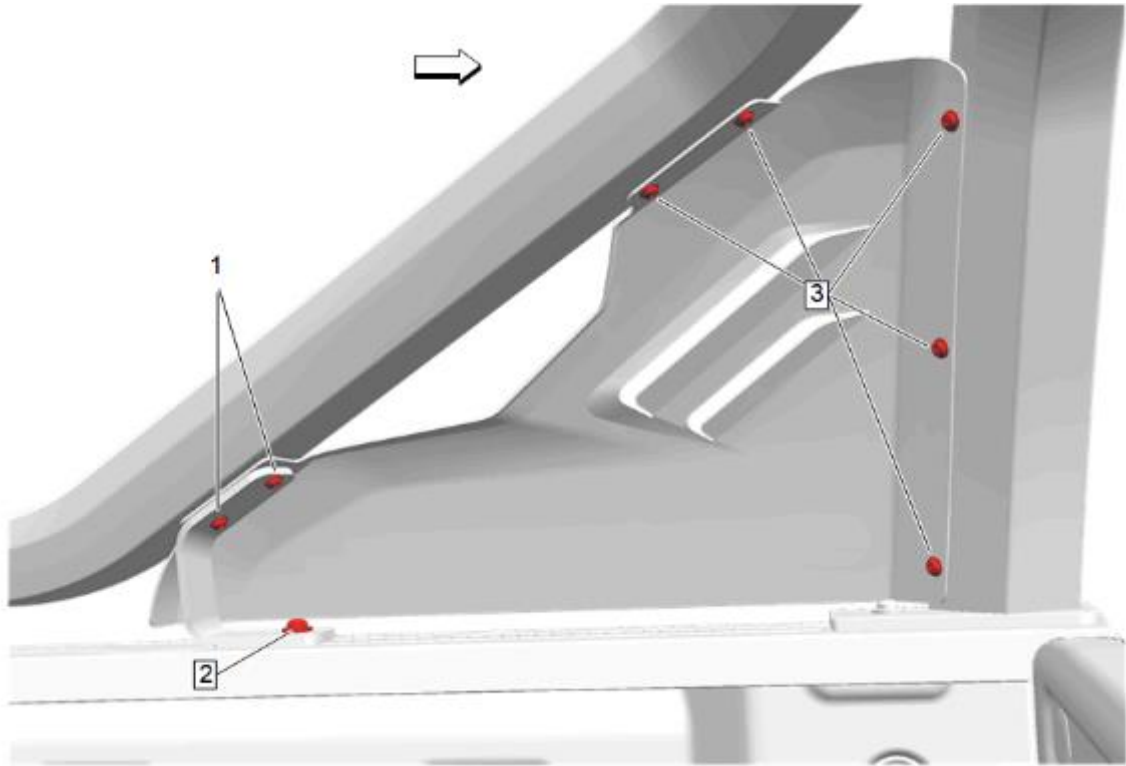

30. Tighten the mid support bracket upper bolts (1) to 10 N.m (7 lb ft).
31. Tighten the mid support bracket lower bolt (2).
32. Tighten the side deco plate screws (3) to 10 N.m (7 lb ft).
33. Repeat steps 30 through 32 for opposite side.